

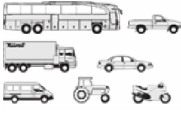

VOLVO - Ø 130,18

87-73671-STD



Motor Özellikleri
(Engine Specifications)

İmalatçı (Manufacturer):
VOLVO
Çap (Diameter): Ø 130,18
FM Grup No: 8824

**TD122 F, TD 122GA,
TD 122GH**

6 Sil. Dizel 12000cc
262 Kw(356 PS) 15:1
Turbo Intercooled
F 12, L 180 K
1987....

TD 122 FK/FR/FS/KE

6 Sil. Dizel 12000cc
290 Kw(395 PS) 15:1
Turbo Intercooled
F 12, FS 10
1987....

TID 121 FG

6 Sil. Dizel 12000cc 13,3:1
Turbo Intercooled
Endüstriyel (Industrial)

Piston Ölçüleri
(Piston Dimensions)

A : 114.200
B- : 25.400
BØ : 79.000
BX : 4.000
C1 : 2.600
D : 175.200
E : 27.800

Pim: 55 x 114



Piston Özellikleri
(Piston Features)

Segman Taşıyıcı
(Ring Carrier)
Gözarası Düz
(Flat Eye Gap)

Piston Parça No
(Piston Part No)

87-501300-42
87-73671-STD

Segman Seti
(Ring Set)

06-501300-80-STD

3.500 CK KV1
3.160 CR GOE
4.747 CR GOE

Silindir Gömleği
(Liner)

14-458180-00-WH

B : 143.880
L : 313.000
D : 157.620
C : 10.520
F : 3.280
R : 18.250

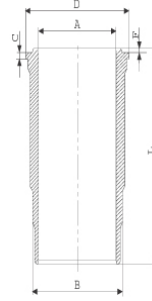

O-Ring Bilgi / Dış Yüzeyi
Fosfat Kaplı (O Ring
Information / Outer
Surface Phosphate
Coated)
24-35028-20/O
1x 145x1,5 FPM
2x143x5,7 EPDM
1x 143x5,7 FPM

14-456000-00-WH

B : 144.000
L : 311.000
D : 157.600
C : 10.520
F : 0.740
R : 18.600

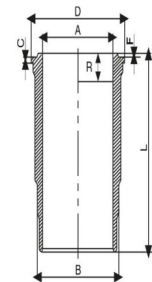

O-Ring Bilgi
(O Ring Information)
24-35028-20/O
1x 145x1,5 FPM
2x143x5,7 EPDM
1x 143x5,7 FPM

Silindir Kit
(Assembly Set)

89-501300-42-STD
89-73671-STD

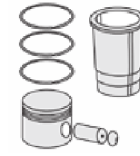

Piston - Blok Montaj
Yüksekliği
(Piston - Block
Assembly Height)

- 0,05 / + 0,45

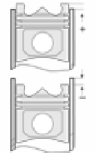



VOLVO - Ø 130,18

87-73671-STD



Motor Özellikleri
(Engine Specifications)

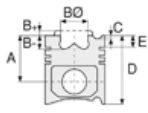

Piston Ölçüleri
(Piston Dimensions)



Piston Parça No
(Piston Part No)



Segman Seti
(Ring Set)



Silindir Gömleği
(Liner)

14-458180-00-WH
O-Ring Bilgi / Dış Yüzeyi
Fosfat Kaplı
(O Ring Information /
Outer Surface
Phosphate Coated)
24-24468-02/O
1x 142,8*5,8 FPM
2x 142,8*5,8 EPDM
1x 141*2,4 FPM

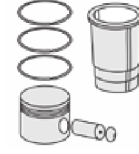

Silindir Kit
(Assembly Set)

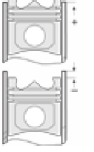

Piston - Blok Montaj
Yüksekliği
(Piston - Block
Assembly Height)





VOLVO - Ø 130,18

87-73671-STD



Motor Özellikleri
(Engine Specifications)

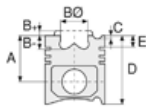

Piston Ölçüleri
(Piston Dimensions)



Piston Parça No
(Piston Part No)



Segman Seti
(Ring Set)



Silindir Gömleği
(Liner)

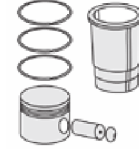

Silindir Kit
(Assembly Set)

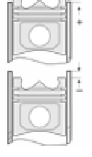

Piston - Blok Montaj
Yüksekliği
(Piston - Block
Assembly Height)

ANA YATAK
(MAIN BEARING)

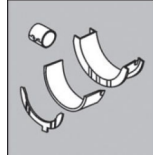

H1053/7 STD

KOL YATAK
(ARM BED)

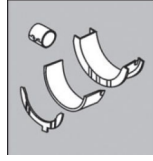

71-4236/6 STD

71-3613/6 STD

EKSANTRİK YATAK
(ECCENTRIC BEARING)

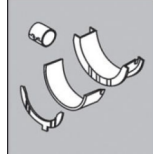

N157/7 STD

AY YATAK
(THRUST WASHER)

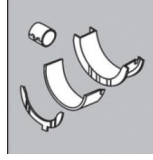

A131/4 STD

KOL BURCU
(SMALL END BUSH)

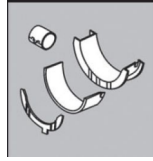

55-3925 SEMI

SİL. KAPAK. CONTA
(CYLINDER HEAD GASKET)



DT850

