



VOLVO - Ø 130,18

87-73672-STD



Motor Özellikleri
(Engine Specifications)

İmalatçı (Manufacturer):
VOLVO
Çap (Diameter): Ø 130,18
FM Grup No: 8823

TAMD 120 A /120 BCC
/120 C/120 E

6 Sil. Dizel 12000cc
226-265 Kw(308-360 PS)
14,2:1
Turbo Intercooled
CH 230 T, F 12
1980 - 1984

TAMD 120 AK

6 Sil. Dizel 12000cc
226-265 Kw(308-360 PS)
14,2:1
Turbo Intercooled
CH 230 T, F 12
1980 - 1984

TAMD 120 B

6 Sil. Dizel 12000cc
226-265 Kw(308-360 PS)
14,2:1
Turbo Intercooled
CH 230 T, F 12
1980 - 1984

TD 120 F- TD 121 G

6 Sil. Dizel 12000cc
226-265 Kw(308-360 PS)
14,2:1
Turbo Intercooled
CH 230 T, F 12

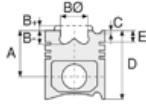

Piston Ölçüleri
(Piston Dimensions)

A : 114.200
B- : 27.940
BØ : 79.000
BX : 4.000
C1 : 2.500
D : 175.200
E : 27.150

Pim: 55 x 114

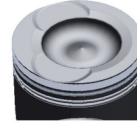

Piston Özellikleri
(Piston Features)

Segman Taşıyıcı
(Ring Carrier)
Gözarası Düz
(Flat Eye Gap)



Piston Parça No
(Piston Part No)

87-501300-22
87-73672-STD



Segman Seti
(Ring Set)

06-501300-80-STD

3.500 CK KV1
3.160 CR GOE
4.747 CR GOE



Silindir Gömleği
(Liner)

14-458180-00-WH
B : 143.880
L : 313.000
D : 157.620
C : 10.520
F : 3.280
R : 18.250

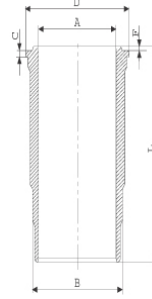

O-Ring Bilgi / Dış Yüzeyi
Fosfat Kaplı (O Ring
Information / Outer
Surface Phosphate
Coated)

24-24468-02/O
1x 142,8*5,8 FPM
2x 142,8*5,8 EPDM
1x 141*2,4 FPM

14-451120-00
B : 144.000
L : 311.000
D : 157.600
C : 13.520
F : 0.760
R : 18.000

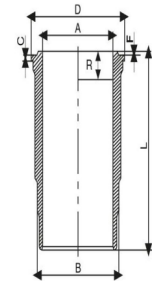

O-Ring Bilgi Kanal
(O-Ring Information
Channel)

24-35031-11/O
1x 142,8*5,8 FPM
1x 142,8*5,8 EPDM
1x 141*2,4 FPM
1x 138*143*11 NBR

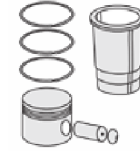

Silindir Kit
(Assembly Set)

89-501300-22-STD
89-73672-STD

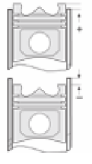

Piston - Blok Montaj
Yüksekliği
(Piston - Block
Assembly Height)

- 0,05 / + 0,45





Motor Özellikleri
(Engine Specifications)

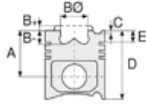

Piston Ölçüleri
(Piston Dimensions)



Piston Parça No
(Piston Part No)



Segman Seti
(Ring Set)



Silindir Gömleği
(Liner)

14-451130-00-WH
B : 144.000
L : 311.000
D : 157.600
C : 10.520
F : 0.740
R : 18.600

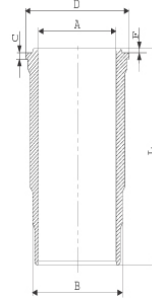

O-Ring Bilgi /
O-Ring Kanalı 3,25 mm
(O-Ring Information /
O-Ring Information
Channel 3,25 mm)
24-24468-O2/O
1x 142,8*5,8 FPM
2x 142,8*5,8 EPDM
1x 141*2,4 FPM

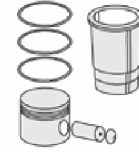

Silindir Kit
(Assembly Set)

89-501300-73-STD
89-73672-STD B

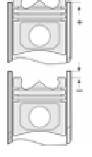

Piston - Blok Montaj
Yüksekliği
(Piston - Block
Assembly Height)

14-456000-00-WH
B : 144.000
L : 311.000
D : 157.600
C : 10.520
F : 0.740
R : 18.600

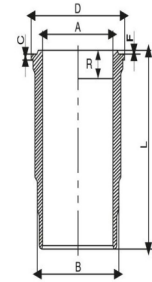

O-Ring Bilgi
(O-Ring Information)
24-35028-20/O
1x 145x1,5 FPM
2x143x5,7 EPDM
1x 143x5,7 FPM

89-501300-74-STD
89-73672-STD C





Motor Özellikleri
(Engine Specifications)

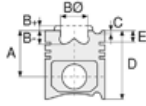

Piston Ölçüleri
(Piston Dimensions)



Piston Parça No
(Piston Part No)



Segman Seti
(Ring Set)



Silindir Gömleği
(Liner)

14-450530-00-WH
B : 144.000
L : 311.000
D : 157.600
C : 13.520
F : 0.760
R : 18.000

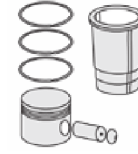

Silindir Kit
(Assembly Set)

89-501300-75-STD
89-73672-STDD

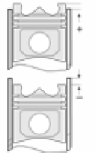

Piston - Blok Montaj
Yüksekliği
(Piston - Block
Assembly Height)

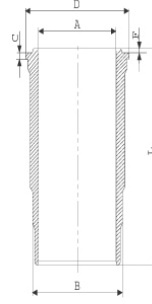

O-Ring Bilgi
(O-Ring Information)
24-35031-11/O
1X142,8*5,8 FPM
1X142,8*5,8 EPDM
1X141*2,4 FPM
1X138?143*11 NBR

14-458180-00-WH
O-Ring Bilgi / Dış Yüzeyi
Fosfat Kaplı
(O-Ring Information /
Outer Surface
Phosphate Coated)
24-24468-02/O
1x 142,8*5,8 FPM
2x 142,8*5,8 EPDM
1x 141*2,4 FPM





VOLVO - Ø 130,18

87-73672-STD

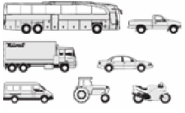

Motor Özellikleri
(Engine Specifications)

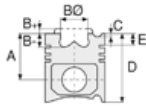

Piston Ölçüleri
(Piston Dimensions)



Piston Parça No
(Piston Part No)



Segman Seti
(Ring Set)



Silindir Gömleği
(Liner)

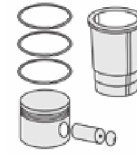

Silindir Kit
(Assembly Set)

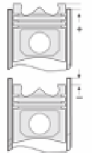

Piston - Blok Montaj
Yüksekliği
(Piston - Block
Assembly Height)

ANA YATAK
(MAIN BEARING)

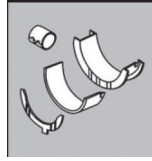

H1053/7 STD

KOL YATAK
(ARM BED)

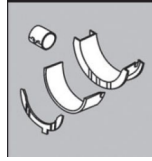

71-4236/6 STD

71-3613/6 STD

EKSANTRİK YATAK
(ECCENTRIC BEARING)

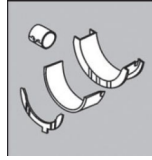

N157/7 STD

AY YATAK
(THRUST WASHER)

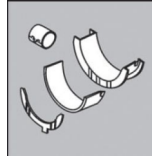

A131/4 STD

KOL BURCU
(SMALL END BUSH)

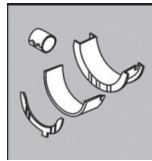

55-4509 SEMI

SİL. KAPAK. CONTA
(CYLINDER HEAD GASKET)



DE240

