



VOLVO - Ø 131

87-73681-STD



**Motor Özellikleri**  
(Engine Specifications)

İmalatçı (Manufacturer):  
VOLVO  
Çap (Diameter): Ø 131  
FM Grup No: 880148

**D 12 D Euro3**  
6 Sil. Dizel 12100cc  
279 kW(380 PS)  
FH 12, Sabit Motor (Fixed  
Engine)  
1997....

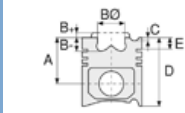

**Piston Ölçüleri**  
(Piston Dimensions)

A : 87.250  
B- : 17.150  
BØ : 89.000  
D : 137.450  
E : 14.050

Pim: 55 x 107



**Piston Özellikleri**  
(Piston Features)

Segman Taşıyıcı  
(Ring Carrier)  
Sert Anotlama  
(Hard Anodizing)  
Yağ Püskürtme Oyuğu  
(Oil Jet Cut-out)  
Gözarası Konik  
(Conical Eye Gap)

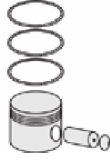

**Piston Parça No**  
(Piston Part No)

87-123200-92  
87-73681-STD



**Segman Seti**  
(Ring Set)

06-123200-20-STD

4.000 CK KV1  
3.000 GOE  
4.000 NT ST



**Silindir Gömleği**  
(Liner)

14-450590-00-WH  
B : 144.000  
L : 272.800  
D : 159.600  
C : 11.200  
F : 0.900

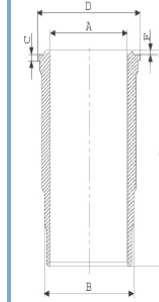

Euro 6 Malzemeli /  
O-Ring Bilgi  
(Euro 6 Material /  
O-Ring Information)  
24-24468-02/O  
1x 142,8\*5,8 FPM  
2x 142,8\*5,8 EPDM  
1x 141\*2,4 FPM

14-450590-00-WH  
Euro 6 Malzemeli /  
O-Ring Bilgi  
(Euro 6 Material /  
O-Ring Information)  
24-24468-02/O  
1x 142,8\*5,8 FPM  
2x 142,8\*5,8 EPDM  
1x 141\*2,4 FPM

14-451270-00-WH  
B : 144.000  
L : 272.800  
D : 159.600  
C : 11.200  
F : 0.900

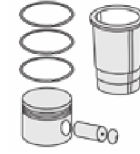
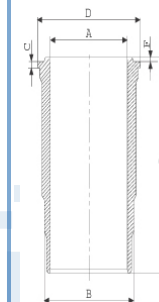

**Silindir Kit**  
(Assembly Set)

89-123200-92-STD  
89-73681-STD

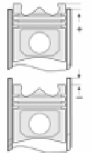

**Piston - Blok Montaj**  
Yüksekliği  
(Piston - Block  
Assembly Height)

+0,15/+0,65





VOLVO - Ø 131

87-73681-STD



**Motor Özellikleri**  
(Engine Specifications)

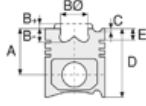

**Piston Ölçüleri**  
(Piston Dimensions)



**Piston Parça No**  
(Piston Part No)



**Segman Seti**  
(Ring Set)



**Silindir Gömleği**  
(Liner)

Euro 6 Malzemeli /  
O-Ring Bilgi  
(Euro 6 Material /  
O-Ring Information)  
24-24468-02/O  
1x 142,8\*5,8 FPM LILA  
2x 142,8\*5,8 EPDM  
1x 141\*2,4 FPM

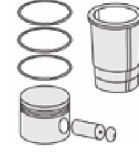

**Silindir Kit**  
(Assembly Set)

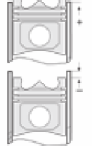

**Piston - Blok Montaj**  
**Yüksekliği**  
(Piston - Block  
Assembly Height)

**ANA YATAK**  
(MAIN BEARING)

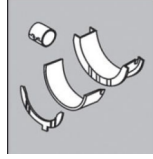

H1015/7 STD

**KOL YATAK**  
(ARM BED)

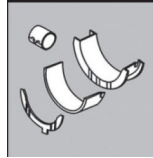

71-3923/6 STD

**AY YATAK**  
(THRUST WASHER)

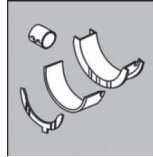

A131/4 STD

**KOL BURCU**  
(SMALL END BUSH)

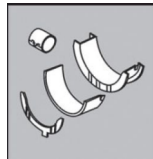

55-3925 SEMI

**SİL. KAPAK. CONTA**  
(CYLINDER HEAD GASKET)



AF5280

