

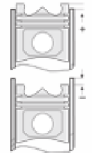

VOLVO - Ø 131

87-73683-STD

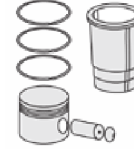
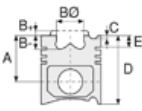

Motor Özellikleri
(Engine Specifications)

İmalatçı (Manufacturer):
VOLVO
Çap (Diameter): Ø 131
FM Grup No: 880158

D13A EURO 3

6 Sil. Dizel 12800cc
264-294-323-353 KW /
360-400-440-480 PS
FH, FM
2005...

Piston Ölçüleri
(Piston Dimensions)

A : 84.150
B - : 18.200
BØ : 89.000
D : 130.700
E : 14.100

Pim: 58 x 104



Piston Özellikleri
(Piston Features)

Segman Taşıyıcı
(Ring Carrier)
Soğutma Kanallı
(Coolin Gallery)
Yağ Püskürtme Oyuğu
(Oil Jet Cut-out)
Gözarası Konik
(Conical Eye Gap)

Piston Parça No
(Piston Part No)

87-833500-22
87-73683-STD

Segman Seti
(Ring Set)

06-833500-20-STD

3.500 PVD ST
2.500 NT ST
3.000 NT ST

Silindir Gömleği
(Liner)

14-451190-00-WH

B : 144.000
L : 261.800
D : 159.600
C : 11.200
F : 0.900

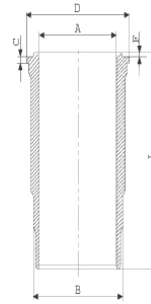

Euro 6 Malzemeli /
O-Ring Bilgi
(Euro 6 Material /
O-Ring Information)
24-24468-02/O
1x 142,8*5,8 FPM
2x 142,8*5,8 EPDM
1x 141*2,4 FPM

Silindir Kit
(Assembly Set)

89-833500-22-STD
89-73683-STD

Piston - Blok Montaj
Yüksekliği
(Piston - Block
Assembly Height)

-0,10/+1,10





VOLVO - Ø 131

87-73683-STD



Motor Özellikleri
(Engine Specifications)



Piston Ölçüleri
(Piston Dimensions)



Piston Parça No
(Piston Part No)



Segman Seti
(Ring Set)



Silindir Gömleği
(Liner)

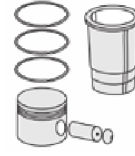

Silindir Kit
(Assembly Set)



Piston - Blok Montaj
Yüksekliği
(Piston - Block
Assembly Height)

ANA YATAK
(MAIN BEARING)

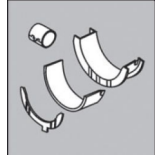

H1015/7 STD

KOL YATAK
(ARM BED)

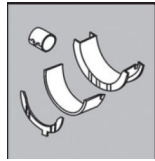

71-4052/6 STD

71-4949/6 STD

AY YATAK
(THRUST WASHER)

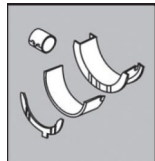

A131/4 STD

KOL BURCU
(SMALL END BUSH)

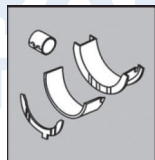

55-4054 SEMI

