



Motor Özellikleri
(Engine Specifications)

İmalatçı (Manufacturer):
MERCEDES BENZ LKW
Çap (Diameter): Ø 128
FM Grup No: 5994

OM441LA EURO2

6 Sil. Dizel 10964cc
180/250 KW
(245/340 PS) 17,25:1
Turbo , Intercool
1234, 1424, 1427, 1733,
1824, 1831, 1834, 2024,
2031, 2524, 2527, 2531,
2631, 3233, 3234,
3534, O404
1991....

OM442LA EURO2

8 Sil. Dizel 14618cc
320/390 KW
(435/530 PS) 17,25:1
Turbo , Intercool
1835, 1838, 1844, 1850,
1853, 2038, 2044, 2050,
2535, 2538, 2544, 2550,
2553, 2629, 2638, 2644,
2650, 2653, 3238, 3244,
3253, 3538, 3544, 3550,
3553, 4838, 4844, 4853,
Actros 1844, O 404
1995....

Piston Ölçüleri
(Piston Dimensions)

A : 81.350
B- : 24.000
BØ : 72.500
BX : 3.000
BY : 1.500
D : 126.350
E : 18.050

Pim: 46 x 105

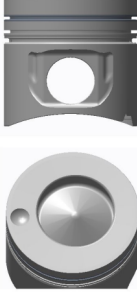

Piston Özellikleri
(Piston Features)

Segman Taşıyıcı
(Ring Carrier)
Soğutma Kanallı
(Coolin Gallery)
Yağ Püskürtme Oyuğu
(Oil Jet Cut-out)
Gözarası Konik
(Conical Eye Gap)

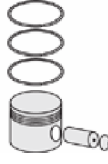

Piston Parça No
(Piston Part No)

87-179300-92
87-70511-STD



Segman Seti
(Ring Set)

06-179300-20-STD
3.000 PS ST
3.000 CR IKA
4.000 CK STD
Goetze® LKZ-Ring®



Silindir Gömleği
(Liner)

14-452030-00-WH
B : 144.500
L : 253.000
D : 153.800
C : 9.920
F : 1.000

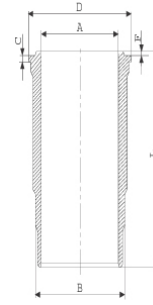

O-RİNG Bilgi
(O-RING Information)
24-26802-00/O
2x 144*3,8 FPM
1x 140*1,9 FPM
1 ADET SHIM

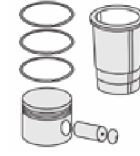

Silindir Kit
(Assembly Set)

89-179300-92-STD
89-70511-STD

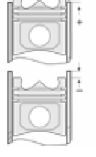

Piston - Blok Montaj
Yüksekliği
(Piston - Block
Assembly Height)

-0,07 / +0,43

14-451160-00-WH
B : 144.500
L : 253.000
D : 153.800
C : 10.070
F : 1.000

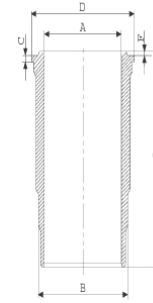

O-RİNG Bilgi
(O-RING
Information)
24-35005-00/O
2x 140*1,9 FPM
2x 144*3,8 FPM

89-179300-84-STD
89-70511-STD





MERCEDES BENZ LKW - Ø 128

87-70511-STD



Motor Özellikleri
(Engine Specifications)



Piston Ölçüleri
(Piston Dimensions)



Piston Parça No
(Piston Part No)



Segman Seti
(Ring Set)



Silindir Gömleği
(Liner)

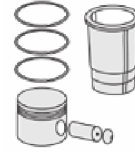

Silindir Kit
(Assembly Set)



Piston - Blok Montaj
Yüksekliği
(Piston - Block
Assembly Height)

ANA YATAK
(MAIN BEARING)

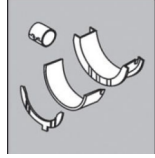

H821/5 STD

KOL YATAK
(ARM BED)

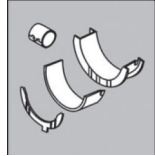

71-3009 STD

71-3289/2 STD

71-2965 STD

AY YATAK
(THRUST WASHER)

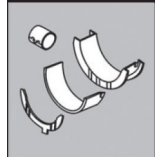

N110/5L SEMI

KOL BURCU
(SMALL END BUSH)

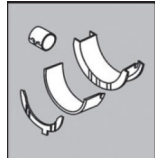

55-3328 SEMI

SİL. KAPAK. CONTA
(CYLINDER HEAD GASKET)

30-024941-30

30-026235-10

30-026235-30





Motor Özellikleri
(Engine Specifications)

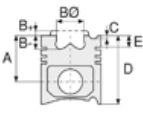

Piston Ölçüleri
(Piston Dimensions)



Piston Parça No
(Piston Part No)



Segman Seti
(Ring Set)



Silindir Gömleği
(Liner)

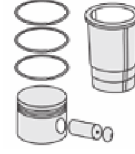

Silindir Kit
(Assembly Set)

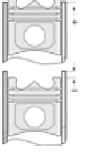

Piston - Blok Montaj
Yüksekliği
(Piston - Block
Assembly Height)

SİL. KAPAK. CONTA
(CYLINDER HEAD GASKET)



21-26235-26/0

ÜST BÖLÜM TAKIM CONTA
(UPPER PART KIT GASKET)



22-23578-04/0

ALT BÖLÜM TAKIM CONTA
(LOWER SECTION KIT GASKET)



20-26235-42/0

