



MERCEDES BENZ LKW - Ø 128

87-70523-STD A



**Motor Özellikleri**  
(Engine Specifications)

İmalatçı (Manufacturer):  
MERCEDES BENZ LKW  
Çap (Diameter): Ø 128  
FM Grup No: 5959

**OM 441A**  
6 Sil. Dizel 10960cc  
200 Kw (272 PS)  
16,25:1  
Turbo  
O 303  
1991 - 1996

**OM 441LA, OM 442LA**  
6 Sil. Dizel 10960cc  
243/249 KW  
(330/340 PS) 16,25:1  
Turbocharged  
Intercool  
1234, 1622, 1628,  
1733, 1834, 2433,  
2534, 3234  
1991 - 1996

**OM 442A.900/941/  
946/950/952/  
954/968**  
8 Sil. Dizel 14618cc  
269 KW  
(366 PS) 16,25:1  
Turbo  
1644, 1735, 1748,  
1844, 1944, 2044,  
2235, 2244, 2435,  
2448, 2535, 2544,  
2635, 2644, 3335,  
3548, O 303  
1991 - 1996

**OM 443A**  
10 Sil. Dizel 18627cc  
340 KW  
(462 PS) 16,25:1  
Turbo Motor  
no:622824-->  
Endüstriyel (Industrial)  
1991 - 1996

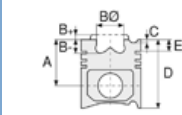

**Piston Ölçüleri**  
(Piston Dimensions)

A : 81.300  
B - : 27.500  
BØ : 66.600  
BX : 2.800  
BY : 1.500  
D : 126.350  
E : 17.900

Pim: 46 x 105



**Piston Özellikleri**  
(Piston Features)

Segman Taşıyıcı  
(Ring Carrier)  
Sert Anotlama  
(Hard Anodizing)  
Gözarası Konik  
(Conical Eye Gap)



**Piston Parça No**  
(Piston Part No)

87-179300-23  
87-70523-STD A



**Segman Seti**  
(Ring Set)

06-179300-20-STD  
3.000 PS ST  
3.000 CR IKA  
4.000 CR STD  
Goetze® LKZ-Ring®



**Silindir Gömleği**  
(Liner)

14-452030-00-WH  
B : 144.500  
L : 253.000  
D : 153.800  
C : 9.920  
F : 1.000

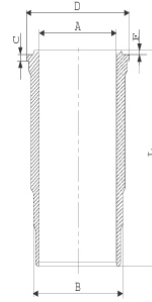

O-RING Bilgi  
(O-RING Information)  
24-26802-00/O  
2x 144\*3,8 FPM  
1x 140\*1,9 FPM  
1 ADET SHIM

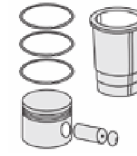

**Silindir Kit**  
(Assembly Set)

89-179300-23-STD  
89-70523-STD A

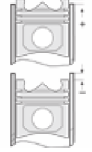

**Piston - Blok Montaj**  
Yüksekliği  
(Piston - Block  
Assembly Height)

+0,17 / +0,53

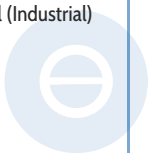



MERCEDES BENZ LKW - Ø 128

87-70523-STD A



**Motor Özellikleri**  
(Engine Specifications)

**OM 443LA**  
10 Sil. Dizel 18267cc  
412 KW  
(560 PS) 16,25:1  
Turbocharged  
Intercool Motor  
no:622824-->  
Endüstriyel (Industrial)  
1991 - 1996

**OM 444A**  
12 Sil. Dizel 21920cc  
16,25:1  
Turbo Motor  
no:012921-->  
Endüstriyel (Industrial)  
1991 - 1996

**OM 444LA**  
12 Sil. Dizel 21920cc  
498/621 KW  
(677/832 PS) 16,25:1  
Turbocharged  
Intercool Motor  
no:012921-->  
Endüstriyel (Industrial)  
1991 - 1996

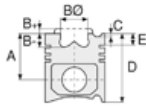

**Piston Ölçüleri**  
(Piston Dimensions)



**Piston Parça No**  
(Piston Part No)



**Segman Seti**  
(Ring Set)



**Silindir Gömleği**  
(Liner)

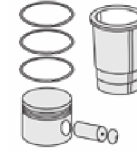

**Silindir Kit**  
(Assembly Set)

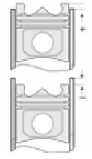

**Piston - Blok Montaj**  
Yüksekliği  
(Piston - Block  
Assembly Height)

**ANA YATAK**  
(MAIN BEARING)

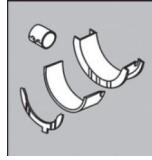

H821/4 STD

**KOL YATAK**  
(ARM BED)

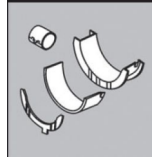

71-3638 STD

71-3289/2 STD

71-2965 STD

**EKSANTRİK YATAK**  
(ECCENTRIC BEARING)

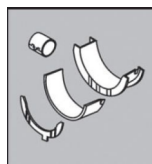

N110/4L STD

**KOL BURCU**  
(SMALL END BUSH)

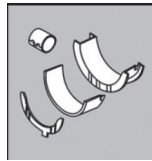

55-3328 SEMI

**SİL. KAPAK. CONTA**  
(CYLINDER HEAD GASKET)

30-024941-30

30-026235-10

30-026235-30





MERCEDES BENZ LKW - Ø 128

87-70523-STDA



**Motor Özellikleri**  
(Engine Specifications)

**OM 443LA**  
10 Sil. Dizel 18267cc  
412 KW  
(560 PS) 16,25:1  
Turbocharged  
Intercool Motor  
no:622824-->  
Endüstriyel (Industrial)  
1991 - 1996

**OM 444A**  
12 Sil. Dizel 21920cc  
16,25:1  
Turbo Motor  
no:012921-->  
Endüstriyel (Industrial)  
1991 - 1996

**OM 444LA**  
12 Sil. Dizel 21920cc  
498/621 KW  
(677/832 PS) 16,25:1  
Turbocharged  
Intercool Motor  
no:012921-->  
Endüstriyel (Industrial)  
1991 - 1996

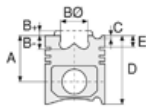

**Piston Ölçüleri**  
(Piston Dimensions)



**Piston Parça No**  
(Piston Part No)



**Segman Seti**  
(Ring Set)



**Silindir Gömleği**  
(Liner)

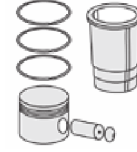

**Silindir Kit**  
(Assembly Set)

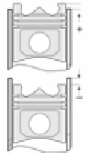

**Piston - Blok Montaj**  
Yüksekliği  
(Piston - Block  
Assembly Height)

**ÜST BÖLÜM TAKIM CONTA**  
(UPPER PART KIT GASKET)



21-26235-26/0

**ALT BÖLÜM TAKIM CONTA**  
(LOWER SECTION KIT GASKET)



22-23578-04/0

**FULL TAKIM CONTA**  
(FULL SET GASKET)



20-26235-42/0

