



MAN - Ø 128

87-71545-STD A



Motor Özellikleri
(Engine Specifications)

İmalatçı (Manufacturer):
MAN
Çap (Diameter): Ø 128
FM Grup No: 5471

D2842 LE202
12 Sil. Dizel 21930cc
446-587 KW (607-798 PS)
Marin, Endüstriyel
(Marine, Industrial)
1997....

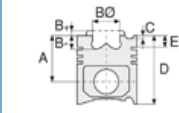

Piston Ölçüleri
(Piston Dimensions)

A : 81.250
B- : 27.100
BØ : 80.200
C1 : 1.300
D : 130.000
E : 18.800

Pim: 46 x 105



Piston Özellikleri
(Piston Features)

Segman Taşıyıcı
(Ring Carrier)
Yağ Püskürtme Oyuğu
(Oil Jet Cut-out)
Burçlu Piston
(Bushing Piston)
Gözarası Konik
(Conical Eye Gap)



Piston Parça No
(Piston Part No)

87-124500-72
87-71545-STD A



Segman Seti
(Ring Set)

06-124500-20-STD
4.000 CK KV4
3.000 GOE
4.000 CR GOE
Goetze® LKZ-Ring® /
Yağ Segmanı Matkap
Delik (Oil Ring Drill Hole)



Silindir Gömleği
(Liner)

14-458210-00-WH
B : 144.500
L : 253.000
D : 153.800
C : 10.050
F : 1.000

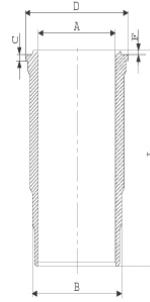

Dış Yüzeyi Fosfat Kaplı /
O-RING Bilgi
(Outer Surface
Phosphate Coated /
O-RING Information)
24-32448-70/O
2x 138*2,1 FPM
2x 144*4 FPM

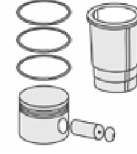

Silindir Kit
(Assembly Set)

89-124500-72-STD
89-71545-STD A

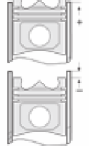

Piston - Blok Montaj
Yüksekliği
(Piston - Block
Assembly Height)





MAN - Ø 128

87-71545-STD A



Motor Özellikleri
(Engine Specifications)



Piston Ölçüleri
(Piston Dimensions)



Piston Parça No
(Piston Part No)



Segman Seti
(Ring Set)



Silindir Gömleği
(Liner)

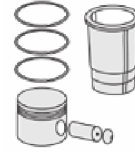

Silindir Kit
(Assembly Set)



Piston - Blok Montaj
Yüksekliği
(Piston - Block
Assembly Height)

KOL YATAK
(ARM BED)

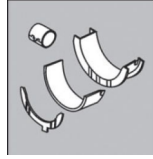

71-3638 STD

71-3289/2 STD

71-2965 STD

EKSANTRİK YATAK
(ECCENTRIC BEARING)

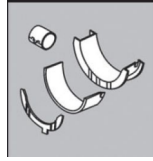

N110/7 STD

KOL BURCU
(SMALL END BUSH)

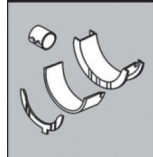

55-2862 SEMI

SİL. KAPAK. CONTA
(CYLINDER HEAD GASKET)



30-026235-10

ÜST BÖLÜM TAKIM CONTA
(UPPER PART KIT GASKET)



21-26235-23/0

