



MERCEDES BENZ LKW - Ø 102

87-72600-STD A



Motor Özellikleri
(Engine Specifications)

İmalatçı (Manufacturer):
MERCEDES BENZ LKW
Çap (Diameter): Ø 102
FM Grup No: 590129

OM 906 LA EURO 5
6 Sil. Dizel 6370cc
210 kw-286 BG 17,4;1
Axor 1829 K, Axor
2529K, Axor 3029 K,
Axor 3029B, Citaro
2006...

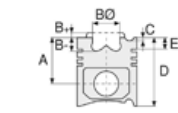

Piston Ölçüleri
(Piston Dimensions)

A : 64.400
B- : 13.900
BØ : 73.200
D : 102.400
E : 14.800

Pim: 42 x 80

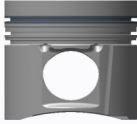

Piston Özellikleri
(Piston Features)

Segman Taşıyıcı
(Ring Carrier)
Sert Anotlama
(Hard Anodizing)
Soğutma Kanallı
(Coolin Gallery)
Yağ Püskürtme Oyuğu
(Oil Jet Cut-out)
Gözarası Konik
(Conical Eye Gap)



Piston Parça No
(Piston Part No)

87-877807-63
87-72600-0501A
0,30 mm Kısa (Short)

87-877800-63
87-72600-STD1A
0,30 mm Kısa (Short)

87-877800-62
87-72600-STD A

87-877807-62
87-72600 0,50A



Segman Seti
(Ring Set)

06-877800-30-STD
06-877807-30 0,50

3.500 CK KV4
2.500 F14
4.000 CK GOE



Silindir Gömleği
(Liner)

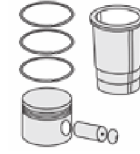

Silindir Kit
(Assembly Set)

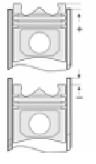

Piston - Blok Montaj
Yüksekliği
(Piston - Block
Assembly Height)

ANA YATAK
(MAIN BEARING)

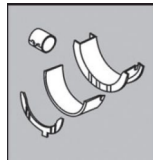

72-4760 STD

SİL. KAPAK. CONTA
(CYLINDER HEAD GASKET)



30-028723-10

30-028723-20

30-028733-20

