



MAN - Ø 120

87-72953-STD



**Motor Özellikleri**  
(Engine Specifications)

İmalatçı (Manufacturer):  
MAN  
Çap (Diameter): Ø 120  
FM Grup No: 5505

**D 2066LF 03 EURO 3**  
6 Sil. Dizel 10520cc  
316 KW-430 PS  
TGA 18.350, TGA 18.390,  
TGA 24.430, TGA 26.350,  
TGA18.430

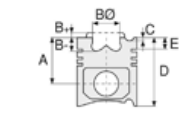

**Piston Ölçüleri**  
(Piston Dimensions)

A : 76.800  
B - : 20.000  
BØ : 70.000  
C1 : 1.500  
C2 : 2.000  
D : 121.800  
E : 10.000

Pim: 52 x 96



**Piston Özellikleri**  
(Piston Features)

Segman Taşıyıcı  
(Ring Carrier)  
Soğutma Kanallı  
(Coolin Gallery)  
Yağ Püskürtme Oyuğu  
(Oil Jet Cut-out)  
Gözarası Konik  
(Conical Eye Gap)

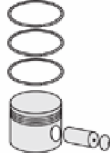

**Piston Parça No**  
(Piston Part No)

87-874000-42  
87-72953-STD



**Segman Seti**  
(Ring Set)

06-874000-20-STD  
3.500 CR KV4  
3.000 CR GOE  
4.000 CR GOE  
Goetze® LKZ-Ring® /  
Yağ Segmanı Matkap  
Delik (Oil Ring Drill Hole)



**Silindir Gömleği**  
(Liner)

14-450630-00-WH  
B : 139.500  
L : 260.000  
D : 150.000  
C : 8.070

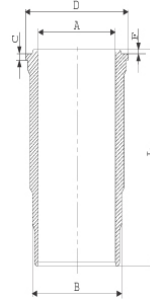

Dış Yüzeyi Fosfat Kaplı /  
O-RING Bilgi  
(Outer Surface  
Phosphate Coated /  
O-RING Information)  
24-35043-60/O  
2x 139,5\*3,95\*4,70 FPM

14-450631-00-WH  
B : 139.500  
L : 260.000  
D : 150.000  
C : 8.570

Flanş ve Boğaz  
Alt Çapı 0,50mm Farklı  
(Flange and Throat  
Bottom Diameter  
0,50mm Different)

14-450632-00-WH  
B : 139.500  
L : 260.000  
D : 150.000  
C : 9.070

Flanş ve Boğaz Alt  
Çapı 1,00mm Farklı  
(Flange and Throat  
Bottom Diameter  
1,00 mm Different)

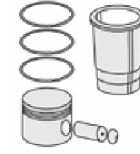

**Silindir Kit**  
(Assembly Set)

89-874000-42-STD  
89-72953-STD

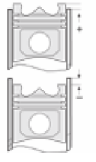

**Piston - Blok Montaj**  
Yüksekliği  
(Piston - Block  
Assembly Height)

