



VOLKSWAGEN - Ø 81,01

87-72197-STD



Motor Özellikleri
(Engine Specifications)

İmalatçı (Manufacturer):
VOLKSWAGEN
Çap (Diameter): Ø 81,01
FM Grup No: 8618

AGX - AHY-ANJ-AJT
5 Sil. Dizel 2459cc 55
Kw (75 PS) 19.5:1
LT 28, LT 35, LT 46
1996 - 2001

AHD-APA-AUF
5 Sil. Dizel 2459cc 74
Kw (101 PS) 19.5:1
Turbo LT 28, LT 35, LT 46
1996 - 1999

ACV-BBF-AYY-BBE
5 Sil. Dizel 2461cc 74
Kw (101 PS) 20.5:1 Turbo
CARAVELLE CL/GL,
CARAVELLE CLUB,
CARAVELLE VARIANT,
TRANSPORTER
1996 - 2003

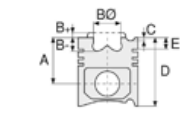

Piston Ölçüleri
(Piston Dimensions)

A : 45.750
B - : 17.200
BØ : 39.700
BX : 6.500
BY : 1.900
C1 : 1.400
D : 69.750
E : 9.000

Pim : 26 x 68

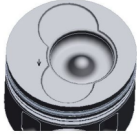

Piston Özellikleri
(Piston Features)

Segman Taşıyıcı
(Ring Carrier)
Sert Anotlama
(Hard Anodizing)
Yağ Püskürtme Oyuğu
(Oil Jet Cut-Out)
Burçlu Piston
(Bushing Piston)
Gözarası Düz
(Flat Eye Gap)



Piston Parça No
(Piston Part No)

87-501500-02
87-72197-STD
1. ve 2. Silindir (Cylinder)

87-501507-02
87-72197-050A

87-501511-02
87-72197-100A

87-501500-22
87-72198-STD
3. - 4. ve 5. Silindir
(Cylinder)

87-501507-22
87-72198-050

87-501511-22
87-72198-100



Segman Seti
(Ring Set)

06-501500-00-STD
06-501507-00-0,50 mm
06-501511-00-1,00 mm
2.500 CKP KV1
2.000 CRP STD
3.000 CRP STD



Silindir Gömleği
(Liner)

14-020420-00-D
B : 84.000
L : 158.000
D : 85.000
C : 5.000

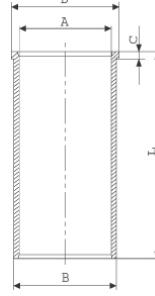

14-020421-00-D
B : 84.500
L : 158.000
D : 85.500
C : 5.500

Dış Çap 0,50mm Farklı
(Outside Diameter
0.50mm Different)

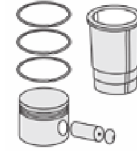

Silindir Kit
(Assembly Set)

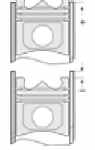

Piston - Blok Montaj
Yüksekliği
(Piston - Block
Assembly Height)

1. Çentik (Notch) 1,53mm
+0,80 / +0,90
2. Çentik (Notch) 1,57mm
+0,90 / +1,00
3. Çentik (Notch) 1,61mm
+1,00 / +1,10





Motor Özellikleri
(Engine Specifications)

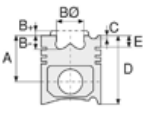

Piston Ölçüleri
(Piston Dimensions)



Piston Parça No
(Piston Part No)



Segman Seti
(Ring Set)



Silindir Gömleği
(Liner)

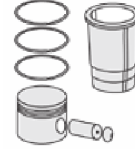

Silindir Kit
(Assembly Set)

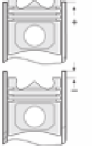

Piston - Blok Montaj
Yüksekliği
(Piston - Block
Assembly Height)

Ana Yatak
(Main Bearing)

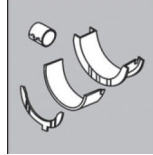

H941/6 S STD

Kol Yatak
(Arm Bed)

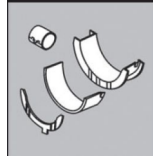

71-3847/5 STD

Ay Yatak
(Thrust Washer)

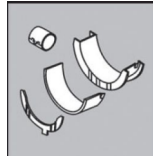

A124/4 STD

Kol Burcu
(Small End Bush)

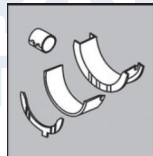

55-3729 SEMI

