

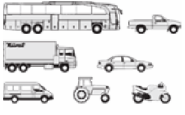

VOLKSWAGEN - Ø 79,51

87-72515-STD



Motor Özellikleri
(Engine Specifications)

İmalatçı (Manufacturer):
VOLKSWAGEN
Çap (Diameter): Ø 79,51
FM Grup No: 860116

CFWA

3 Sil. Dizel 1199cc
55KW-75HP
POLO 1.2 TDİ
2009 - 2014

CAYA

4 Sil. Dizel 1598cc
55 kw-75 ps
Polo 1.6 TDI 16V
2009....

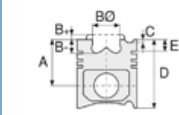

Piston Ölçüleri
(Piston Dimensions)

A : 45.300
B - : 10.700
BØ : 49.000
D : 67.900
E : 12.000

Pim: 26 x 66



Piston Özellikleri
(Piston Features)

Segman Taşıyıcı
(Ring Carrier)
Soğutma Kanallı
(Coolin Gallery)
Gözarası Konik
(Conical Eye Gap)

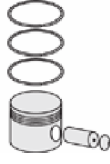

Piston Parça No
(Piston Part No)

87-114900-72
87-72515-STD
87-114907-72
87-72515 0,50



Segman Seti
(Ring Set)

06-114900-00-STD
06-114907-00 0,50 mm
1.750 CKP KV1
2.000 P F14
3.000 CRP STD

Goetze® LKZ-Ring®



Silindir Gömleği
(Liner)

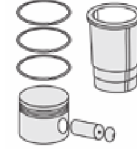

Silindir Kit
(Assembly Set)

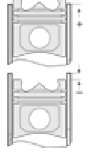

Piston - Blok Montaj
Yüksekliği
(Piston - Block
Assembly Height)

1 Kertik Conta ile
(With Notch Gasket)
0,91/1,00
2 Kertik Conta ile
(With Notch Gasket)
1,01/1,10
3 Kertik Conta ile
(With Notch Gasket)
1,11/1,20

Ana Yatak
(Main Bearing)

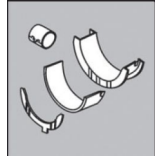

H079/5 STD

Kol Yatak
(Arm Bed)

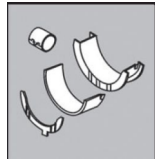

71-3904 STD

Ay Yatak
(Thrust Washer)

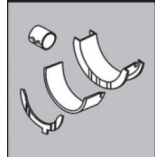

A123/4 STD

Kol Burcu
(Small End Bush)

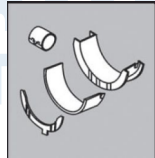

55-3729 SEMI

