



MERCEDES BENZ LKW - Ø 128

87-72585-STD



**Motor Özellikleri**  
(Engine Specifications)

İmalatçı (Manufacturer):  
MERCEDES BENZ LKW  
Çap (Diameter): Ø 128  
FM Grup No: 590101

**OM 460 Euro4-5 /**  
**OM 457 LA Euro 5**

6 Sil. Dizel 11967cc  
260-265-295-315  
Kw(349-360-401-422 Ps)  
Axor 1836LS,  
Axor 1840LS, Axor  
2640CL, Axor 3240C,  
Axor 3340K, Axor  
4140B, Capacity,  
Conecto, Turismo  
15RHD, Travego 15SHD  
2007....

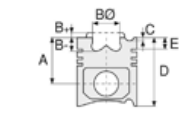

**Piston Ölçüleri**  
(Piston Dimensions)

A : 85.000  
B- : 17.700  
BØ : 87.000  
D : 135.000  
E : 15.000

Pim: 52 x 103

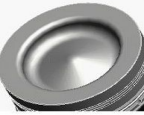

**Piston Özellikleri**  
(Piston Features)

Segman Taşıyıcı  
(Ring Carrier)  
Soğutma Kanallı  
(Coolin Gallery)  
Yağ Püskürtme Oyuğu  
(Oil Jet Cut-out)  
Burçlu Piston  
(Bushing Piston)  
Gözarası Konik  
(Conical Eye Gap)

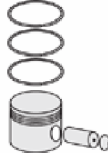

**Piston Parça No**  
(Piston Part No)

87-876000-63  
87-72585-STD1A  
0,20 mm Kısa (Short)  
  
87-876000-64  
87-72585-STD2A  
0,40 mm Kısa (Short)  
  
87-876000-74  
87-72585-STD3A  
0,60 mm Kısa (Short)  
  
87-876000-62  
87-72585-STD4



**Segman Seti**  
(Ring Set)

06-876000-20-STD  
  
3.000 CK ST  
3.000 CR GOE  
4.000 KV1  
  
Goetze® LKZ-Ring® /  
Yağ Segmanı Matkap  
Delikli (Oil Ring Drill  
Perforated)



**Silindir Gömleği**  
(Liner)

14-451070-00-WH  
B : 144.500  
L : 266.300  
D : 155.600  
C : 10.120  
F : 1.100  
R : 6.500

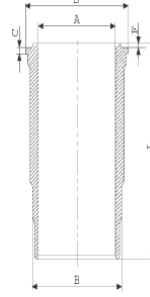

Kurum Giderme Ringli /  
O-RING Bilgi  
(With Soot Removal  
Ring / O-RING  
Information)  
24-35045-70/O  
2x 144\*154\*7 FPM  
1x 132,5\*137\*3,90 FPM  
1 ADET SHIM

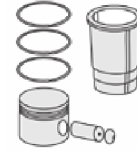

**Silindir Kit**  
(Assembly Set)

89-876000-62-STD  
89-72585-STD4

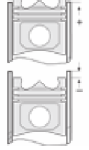

**Piston - Blok Montaj**  
Yüksekliği  
(Piston - Block  
Assembly Height)

+0,35 / +0,55





Motor Özellikleri  
(Engine Specifications)

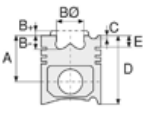

Piston Ölçüleri  
(Piston Dimensions)



Piston Parça No  
(Piston Part No)



Segman Seti  
(Ring Set)



Silindir Gömleği  
(Liner)

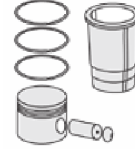

Silindir Kit  
(Assembly Set)



Piston - Blok Montaj  
Yüksekliği  
(Piston - Block  
Assembly Height)

**ANA YATAK  
(MAIN BEARING)**

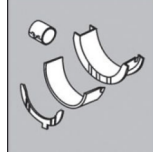

H075/7 STD

**KOL YATAK  
(ARM BED)**

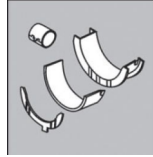

71-4784 STD

71-2965 STD

71-3893/6 STD

**EKSANTRİK YATAK  
(ECCENTRIC BEARING)**

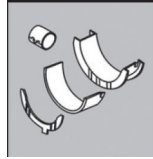

N205/7 SEMI

**SİL. KAPAK. CONTA  
(CYLINDER HEAD GASKET)**

30-030171-00



30-030424-00

AF5370

**ÜST BÖLÜM TAKIM CONTA  
(UPPER PART KIT GASKET)**



21-30171-00/0

**ALT BÖLÜM TAKIM CONTA  
(LOWER SECTION KIT GASKET)**



22-23336-10/0

