

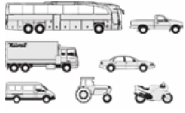

MERCEDES BENZ LKW - Ø 130

87-72564-STD



Motor Özellikleri
(Engine Specifications)

İmalatçı (Manufacturer):
MERCEDES BENZ LKW
Çap (Diameter): Ø 130
FM Grup No: 6020

OM 501/502 LA
EURO 4-5

6 Sil. Dizel 15928cc
405 KW (551 PS) 17. 75:1
BlueTec - Turbo
Intercooled 1836 AK,
1841 LLS, 1844 LS,
1848 LLS, 1850,L,LL,
1851 LS, 1860 L,LL,
2032 K, 2041 AS,
2555 LS, 2654 K,LK,
2655 K,LK, 3236 B,
3336, 3336 AK, 3341 AK,
3341 K, 3341 S, 3354, 3355,
3355 AS, 3355 S, 4141 B,
4151 K
2007...

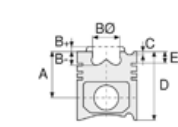

Piston Ölçüleri
(Piston Dimensions)

A : 78.550
B - : 17.600
BØ : 87.000
D : 119.550
E : 15.000

Pim : 52 x 103

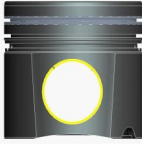

Piston Özellikleri
(Piston Features)

Segman Taşıyıcı
(Ring Carrier)
Soğutma Kanallı
(Cooling Gallery)
Yağ Püskürtme Oyuğu
(Oil Jet Cut-Out)
Burçlu Piston
(Bushing Piston)
Göz Arası Konik
(Conical Eye Gap)



Piston Parça No
(Piston Part No)

87-420900-02
87-72564-STD

87-420900-03
87-72564-STD1
0,20 mm Kısa (Short)

87-136000-62
87-72564-STDB

87-136000-63
87-72564-STD1B
0,20 mm Kısa (Short)



Segman Seti
(Ring Set)

06-420900-20-STD
3.000  GDC ST
3.000  CR GOE
4.000  GDC ST
Yağ Segmanı Matkap Delik
(Oil Ring Drill Hole)

06-136000-20-STD
3.000  CK ST
3.000  CR GOE
4.000  CK KV1
Yağ Segmanı Matkap Delik
(Oil Ring Drill Hole)



Silindir Gömleği
(Liner)

15-451220-00-WH
B : 150.000
L : 258.000
D : 164.200
C : 10.120
F : 1.100
R : 13.500

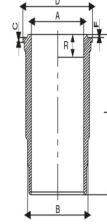

KURUM GİDERME
VE O-RİNGLİ
(With Scraper Rings
And O-ring)
24-35048-60/O
2x 149x158,6x7 FPM
1x 153*163*0,15 SHIM

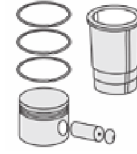

Silindir Kit
(Assembly Set)

89-420900-02-STD
89-72564-STD

89-136000-62
89-72564-STDB

89-136000-63
89-72564-STD1B

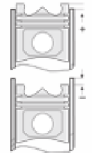

Piston - Blok Montaj
Yüksekliği
(Piston - Block
Assembly Height)

+0,27 / +0,61





Motor Özellikleri
(Engine Specifications)

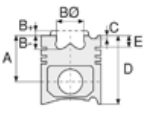

Piston Ölçüleri
(Piston Dimensions)

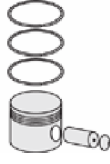

Piston Parça No
(Piston Part No)



Segman Seti
(Ring Set)



Silindir Gömleği
(Liner)

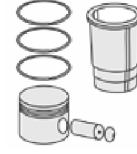

Silindir Kit
(Assembly Set)

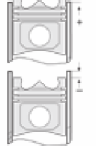

Piston - Blok Montaj
Yüksekliği
(Piston - Block
Assembly Height)

ANA YATAK
(MAIN BED)

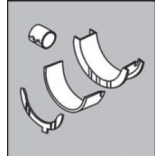

H-063/4-STD

72-3837 STD

KOL YATAK
(ARM BED)

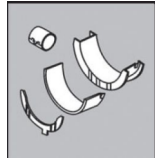

71-4942 STD

71-3835-STD

EKSANTRİK YATAK
(ECCENTRIC BEARING)

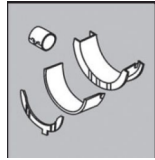

N204/4 SEMI

AY YATAK
(THRUST WASHER)

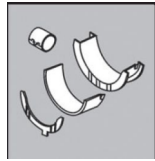

A150/4 STD

SİL. KAPAK. CONTA
(CYLINDER HEAD GASKET)



30-028700-00

30-030172-00

AG8280

ÜST BÖLÜM TAKIM CONTA
(UPPER PART KIT GASKET)



21-28700-50/0

ALT BÖLÜM TAKIM CONTA
(LOWER SECTION KIT GASKET)



22-28700-01/0

