



DAF - Ø 130

87-70436-STDC



**Motor Özellikleri**  
(Engine Specifications)

İmalatçı (Manufacturer):  
DAF  
Çap(Diameter): 130  
FM GrupNo: 2212

**WS 225**  
6 Sil. Dizel 11622cc  
225 Kw (306PS) 14,5:1  
Turbocharged Intercool  
95 310 ATI, 95 310 FA,  
95 310 FT  
1988 - 1991

**WS 259**  
6 Sil. Dizel 11622cc  
259 Kw (352PS) 14,5:1  
Turbocharged Intercool  
95 350 FA, 95 350 FAR,  
95 350 FAT, 95 350 FT  
1988 - 1991

**WS 282**  
6 Sil. Dizel 11622cc  
282 Kw (383PS) 14,8:1  
Turbocharged Intercool  
ATI, FA, FAR, FAS, FAT, FT,  
FTG, FTS, FTT  
1988 - 1991

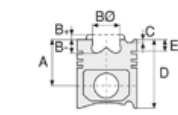

**Piston Ölçüleri**  
(Piston Dimensions)

A : 101.000  
B- : 29.740  
BØ : 75.000  
BX : 5.000  
C1 : 0.800  
C2 : 1.500  
D : 157.000  
E : 24.600

Pim: 52 x 106

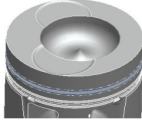

**Piston Özellikleri**  
(Piston Features)

Segman Taşıyıcı  
(Ring Carrier)  
Sert Anotlama  
(Hard Anodizing)  
Gözarası Konik  
(Conical Eye Gap)



**Piston Parça No**  
(Piston Part No)

87-841500-42  
87-70436-STDC



**Segman Seti**  
(Ring Set)

06-841500-20-STD

4.000 CK KV1  
3.160 IKA  
4.000 CRP STD

Goetze® LKZ-Ring® /  
Yağ segmanı matkap  
delikli (Oil Ring Drill  
Perforated)



**Silindir Gömleği**  
(Liner)

14-021410-00-DH  
B : 136.020  
L : 288.300  
D : 143.600  
C : 10.050

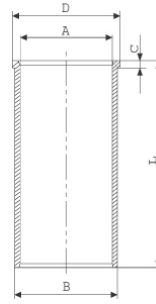

14-021411-00-DH  
B : 136.270  
L : 288.300  
D : 143.600  
C : 10.050

Dış Çap 0,25mm Farklı  
(Outer Diameter  
0,25mm Different)

14-021412-00-DH  
B : 136.520  
L : 288.300  
D : 143.600  
C : 10.050

Dış Çap 0,50mm Farklı  
(Outer Diameter  
0,50mm Different)

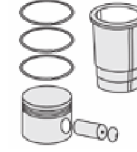

**Silindir Kit**  
(Assembly Set)

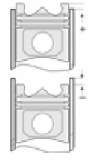

**Piston - Blok Montaj**  
Yüksekliği  
(Piston - Block  
Assembly Height)

-0,10 / +0,20





DAF - Ø 130

87-70436-STD



**Motor Özellikleri**  
(Engine Specifications)



**Piston Ölçüleri**  
(Piston Dimensions)



**Piston Parça No**  
(Piston Part No)



**Segman Seti**  
(Ring Set)



**Silindir Gömleği**  
(Liner)

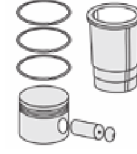

**Silindir Kit**  
(Assembly Set)

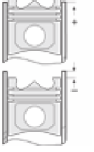

**Piston - Blok Montaj**  
**Yüksekliği**  
(Piston - Block  
Assembly Height)

**Ana Yatak**  
(Main Bearing)

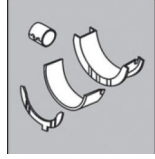

H 005/7-STD

H 022/7-STD

**Kol Yatak**  
(Connecting Rod Bearing)

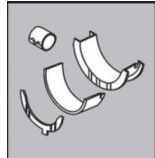

71-3631/6-STD

71-3791/6 STD

**Ay Yatak**  
(Thrust Washer)

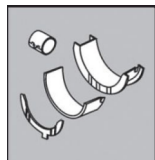

A 023/4-STD

**Kol Burcu**  
(Small End Bushing)

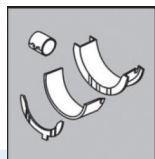

55-3793-SEMİ

**Silindir Kapak Conta**  
(Cylinder Head Gasket)



DW470

21-26590-21/0

