

Motor Özellikleri
(Engine Specifications)

İmalatçı (Manufacturer):
MERCEDES BENZ LKW
Çap (Diameter): Ø 125
FM Grup No: 5955

OM 401.900/
905-909/912-916/
918/919

6 Sil. Dizel 9570cc
136/142 Kw (185/192 PS)
17,5:1
1219, 1419, 1619, 1719, O 303
1972....

OM 402.900/
905-907/910-914/916

8 Sil. Dizel 12760cc
177/188 Kw (240/256 PS)
17,5:1
1424, 1624, 1626, 1926,
2026, 2224, 2226, 2620,
2626, O 303
1972 - 1982

OM 403.910/
001-007/915/919

10 Sil. Dizel 15950cc
184/236 Kw (250/320 PS)
17,5:1
1632, 1932, 2032,
2232, O 303
1972 - 1982

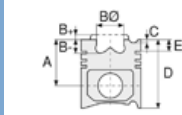

Piston Ölçüleri
(Piston Dimensions)

A : 87.250
B- : 23.500
BØ : 65.000
BX : 6.000
BY : 2.000
D : 137.250
E : 23.940

Pim: 46 x 97

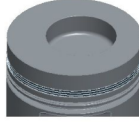

Piston Özellikleri
(Piston Features)

Segman Taşıyıcı
(Ring Carrier)
Yağ Püskürtme Oyuğu
(Oil Spray Groove)
Göz Arası Düz
(Flat Eye Gap)



Piston Parça No
(Piston Part No)

87-176800-42
87-70519-STDB



Segman Seti
(Ring Set)

06-176800-80-STD
3.000 CR KV1
3.000 F14
6.000 CR STD
Goetze® LKZ-Ring®



Silindir Gömleği
(Liner)

14-457860-00-WH
B : 140.000
L : 253.000
D : 152.000
C : 10.070
F : 1.000

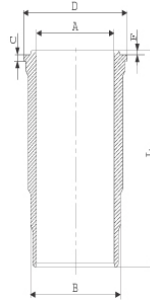

4 O-Ring Lastikli
Dış Yüzeyi Fosfat Kaplı
(With 4 O-Rings
Outer Surface
Phosphate Coated)

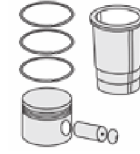

Silindir Kit
(Assembly Set)

89-176800-22-STD
89-70519-STDB

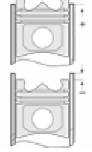

Piston - Blok Montaj
Yüksekliği
(Piston - Block
Assembly Height)

+0,07/+0,43

14-451660-00-WH
B : 140.000
L : 253.500
D : 152.000
C : 10.070
F : 1.000

89-176800-62-STD
89-70519-STDJ

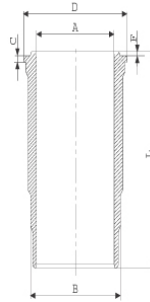

3 O-Ring Lastikli /
O-RING Bilgi
(3 O-Ring Elastic /
O-RING Information)
24-32419-80/O
2x 138*1,9 FPM
1x 140*3,8 FPM





Motor Özellikleri
(Engine Specifications)

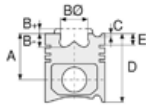

Piston Ölçüleri
(Piston Dimensions)

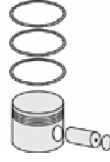

Piston Parça No
(Piston Part No)

87-176800-82
87-70519-STDL



Segman Seti
(Ring Set)

06-176800-70-STD

3.000 CK KV1
3.000 CK IKA
6.000 CR STD
Goetze® LKZ-Ring®



Silindir Gömleği
(Liner)

14-457860-00-WH

4 O-Ring Lastikli Dış
Yüzeyi Fosfat Kaplı
(4 O-Ring Elastic Outer
Surface Phosphate
Coated)

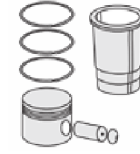

Silindir Kit
(Assembly Set)

89-176800-82-STD
89-70519-STDL

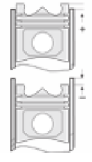

Piston - Blok Montaj
Yüksekliği
(Piston - Block
Assembly Height)

87-115400-02
87-70519-STDV

06-115400-80-STD

3.000 CK KV1
3.000 CR IKA
6.000 CR GOE
Goetze® LKZ-Ring®

87-100200-02
87-70519-STDZ

06-100200-00-STD

3.000 CK KV1
3.000 CK IKA
6.000 CR GOE
Goetze® LKZ-Ring®

14-451660-00-WH

3 O-Ring Lastikli /
O-RING Bilgi
(3 O-Ring Elastic /
O-RING Information)
24-32419-80/O
2x 138*1,9 FPM
1x 140*3,8 FPM

89-176800-83-STD
89-70519-STDZ





Motor Özellikleri
(Engine Specifications)

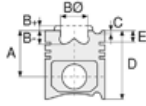

Piston Ölçüleri
(Piston Dimensions)



Piston Parça No
(Piston Part No)



Segman Seti
(Ring Set)



Silindir Gömleği
(Liner)

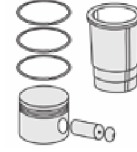

Silindir Kit
(Assembly Set)

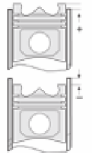

Piston - Blok Montaj
Yüksekliği
(Piston - Block
Assembly Height)

Ana Yatak
(Main Bearing)

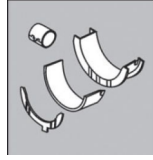

H821/4 STD

Kol Yatak
(Connecting Rod Bearing)

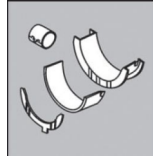

71-2965 STD

71-3009 STD

71-3289/2 STD

Eksantrik Yatak
(Camshaft Bearing)

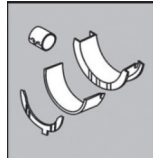

N110/4L STD

Kol Burcu
(Small End Bushing)

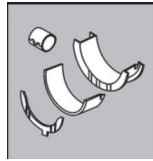

55-2862 SEMI

Silindir Kapak Conta
(Cylinder Head Gasket)



30-024941-30

30-026235-10

30-026235-30

