



MAN - Ø 121

87-71564-STD



Motor Özellikleri
(Engine Specifications)

İmalatçı (Manufacturer):
MAN
Çap (Diameter): Ø 121
FM Grup No: 5413

D 2156 MT/MTN/MTX

6 Sil. Dizel 10344cc
187/210 Kw
(255-285 PS) 17:1
Turbocharged / Saviem
ile ortak motor
(Common Engine With
Turbocharged / Saviem)
13.256 F, 16.256 F,
19.256 F, 22.256 F,
26.256 F, 30.256 F
1966 - 1971

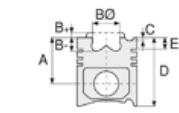

Piston Ölçüleri
(Piston Dimensions)

A : 94.000
B- : 48.350
BØ : 47.200
C1 : 2.400
D : 162.000
E : 20.000

Pim: 45 x 102

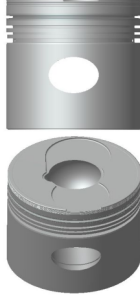

Piston Özellikleri
(Piston Features)

Segman Taşıyıcı
(Ring Carrier)
Sert Anotlama
(Hard Anodizing)
Gözarası Düz
(Flat Eye Gap)

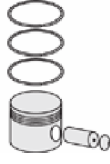

Piston Parça No
(Piston Part No)

87-274800-22
87-71564-STD
87-274800-23
87-71564-STD1
0,20 mm Kısa (Short)
87-274800-24
87-71564-STD2
0,40 mm Kısa (Short)



Segman Seti
(Ring Set)

06-274800-20-STD
3.500 CR IKA
3.000 STD
3.000 STD
5.500 CR STD



Silindir Gömleği
(Liner)

14-020560-00-D
B : 126.100
L : 287.000
D : 132.000
C : 8.200

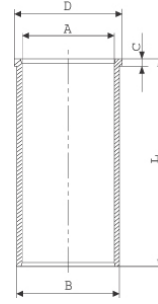

14-020561-00-D
B : 126.600
L : 287.000
D : 132.000
C : 8.200

Dış çap 0,50 mm Farklı
(Outer Diameter
0,50 mm Different)

14-022830-00-DH
B : 125.990
L : 287.000
D : 132.000
C : 8.000

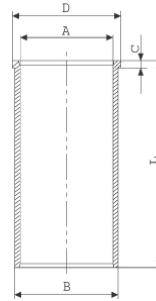

14-022831-00-DH
B : 126.490
L : 287.000
D : 132.000
C : 8.000

Dış çap 0,50 mm farklı
(Outer Diameter
0,50 mm Different)

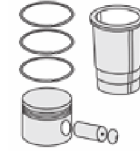

Silindir Kit
(Assembly Set)

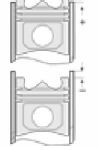

Piston - Blok Montaj
Yüksekliği
(Piston - Block
Assembly Height)

+ 0,05 / + 0,35





MAN - Ø 121

87-71564-STD



Motor Özellikleri
(Engine Specifications)

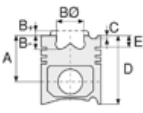

Piston Ölçüleri
(Piston Dimensions)

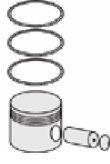

Piston Parça No
(Piston Part No)



Segman Seti
(Ring Set)



Silindir Gömleği
(Liner)

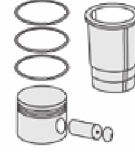

Silindir Kit
(Assembly Set)

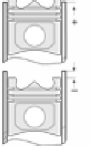

Piston - Blok Montaj
Yüksekliği
(Piston - Block
Assembly Height)

Kol Yatak
(Connecting Rod Bearing)

71-3004 STD

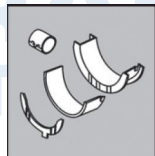

FEDERAL-MOGUL
POWERTRAIN
TÜRKİYE