



MAN - Ø 125

87-71571-STDA



Motor Özellikleri
(Engine Specifications)

İmalatçı (Manufacturer):
MAN
Çap (Diameter): Ø 125
FM Grup No: 5422

D 2538 M/MF/ME

8 Sil. Dizel 12756cc
160/188 Kw
(218/256 PS) 17:1
16.256, 19.256,
26.256, 30.256
1972 - 1976

D 2530 ME/MF/MXF

10 Sil. Dizel 15945cc
156/196/235 Kw
(212/267/320 PS) 17:1
16.320, 19.320,
20.320, 22.320,
26.320, 30.320,
32.320, 38.320,
DF 4525, DF 5175,
DF K-3875
1972 - 1981

Piston Ölçüleri
(Piston Dimensions)

A : 92.300
B- : 44.900
BØ : 54.600
D : 137.300
E : 22.000

Pim: 46 x 97



Piston Özellikleri
(Piston Features)

Segman Taşıyıcı
(Ring Carrier)
Gözarası Konik
(Conical Eye Gap)

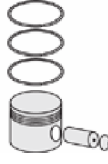

Piston Parça No
(Piston Part No)

87-873700-12
87-71571-STDA



Segman Seti
(Ring Set)

06-873700-20-STD

3.000 CR KV4
3.000 STD
5.000 CR STD



Silindir Gömleği
(Liner)

14-451090-00-WH
B : 140.000
L : 253.000
D : 152.000
C : 10.050
F : 1.000

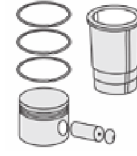
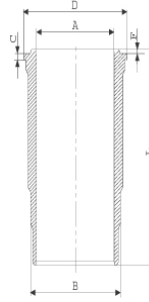

Silindir Kit
(Assembly Set)

89-873700-12-STD
89-71571-STDA

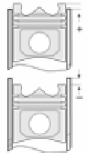

Piston - Blok Montaj
Yüksekliği
(Piston - Block
Assembly Height)

0 / +0,40





MAN - Ø 125

87-71571-STD A



Motor Özellikleri
(Engine Specifications)

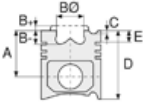

Piston Ölçüleri
(Piston Dimensions)



Piston Parça No
(Piston Part No)



Segman Seti
(Ring Set)



Silindir Gömleği
(Liner)

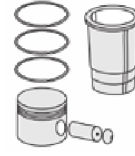

Silindir Kit
(Assembly Set)



Piston - Blok Montaj
Yüksekliği
(Piston - Block
Assembly Height)

Ana Yatak
(Main Bearing)

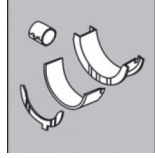

H993/5 STD

Kol Yatak
(Connecting Rod Bearing)

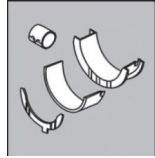

71-3638 STD

71-3324 STD

71-3289/2 STD

Eksantrik Yatak
(Camshaft Bearing)

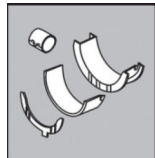

N110/5L STD

Kol Burcu
(Small End Bushing)

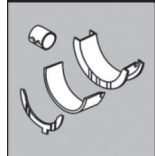

55-2862 SEMI

Silindir Kapak Conta
(Cylinder Head Gasket)



30-025059-10

