



Motor Özellikleri
(Engine Specifications)

İmalatçı (Manufacturer):
MERCEDES BENZ PKW-
RENAULT
Çap (Diameter): Ø 85,01
FM Grup No: 7277

M9T EURO 4/5

4 Sil. Dizel 2298cc 74-107
KW/101-146PS MASTER III
2.3 DCI 100, MASTER III
2.3 DCI 125
2010...

**OM 699.300 /
OM 699.301**

4 Sil. Dizel 2298cc 120-140
KW/163-190PS
X 220 d, X 250 d
2017...

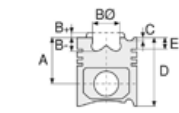

Piston Ölçüleri
(Piston Dimensions)

A : 48.000
B- : 16.200
BØ : 50.000
BY : 0.500
C1 : 0.450
D : 76.000
E : 9.100

Pim : 32 x 65



Piston Özellikleri
(Piston Features)

Segman Taşıyıcı
(Ring Carrier)
Soğutma Kanallı
(Cooling Gallery)
Yağ Püskürtme Oyuğu
(Oil Jet Cut-Out)
Gözarası Konik
(Conical Eye Gap)



Piston Parça No
(Piston Part No)

87-888207-03
87-71959-0501
0,20 mm Kısa (Short)

87-888200-02
87-71959-STD

87-888205-02
87-71959-0,25

87-888207-02
87-71959-0,50

87-888200-03
87-71959-STD1
0,20 mm Kısa (Short)



Segman Seti
(Ring Set)

06-888200-90-STD
06-888205-90-0,25
06-888207-90-0,50 mm

2.500 CKP KV1
2.000 CKP GOE
2.000 CRP GOE

Yağ Segmanı Matkap Delik
(Oil Ring Drill Hole)



Silindir Gömleği
(Liner)

14-022350-00-D
B : 88.000
L : 168.000
D : 89.500
C : 5.000

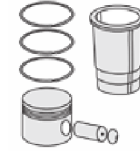
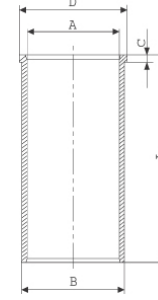

Silindir Kit
(Assembly Set)

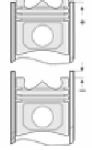

Piston - Blok Montaj
Yüksekliği
(Piston - Block
Assembly Height)

+0,30 / +0,60

Ana Yatak
(Main Bearing)

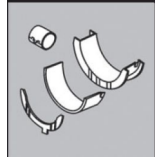

H1327/5 STD

Kol Yatak
(Connecting Rod Bearing)

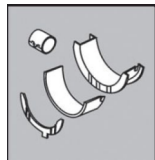

71-4940 STD

Kol Burcu
(Small End Bushing)

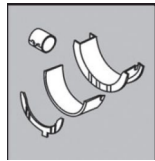

55-4562 SEMI

Ay Yatak
(Thrust Washer)

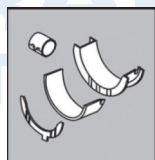

A297/2 STD

