



MERCEDES BENZ LKW - Ø 106

87-72520-STD



**Motor Özellikleri**  
(Engine Specifications)

İmalatçı (Manufacturer):  
MERCEDES BENZ LKW  
Çap (Diameter): Ø 106  
FM Grup No: 590136

**M 906 LAG EURO**  
**5 CNG ENGINE**

6 Sil. CNG 6884cc  
170-205KW/231-279PS  
10,5;1  
1828, 2628,  
BREDAMENARINIBUS  
VIVACITY VIVA  
2000....

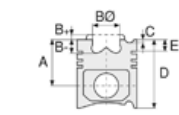

**Piston Ölçüleri**  
(Piston Dimensions)

A : 66.400  
B- : 22.500  
BØ : 85.000  
D : 101.200  
E : 15.000

Pim: 42 x 80



**Piston Özellikleri**  
(Piston Features)

Segman Taşıyıcı  
(Ring Carrier)  
Yağ Püskürtme Oyuğu  
(Oil Jet Cut-out)  
Gözarası Konik  
(Conical Eye Gap)



**Piston Parça No**  
(Piston Part No)

87-878100-02  
87-72520-STD  
  
87-878107-02  
87-72520 0,50



**Segman Seti**  
(Ring Set)

06-878100-20-STD  
06-878107-20 0,50

3.000  CKS KV4  
2.500  CR GOE  
4.000  CR GOE



**Silindir Gömleği**  
(Liner)

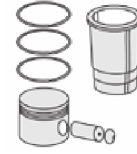

**Silindir Kit**  
(Assembly Set)

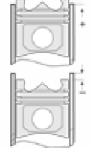

**Piston - Blok Montaj**  
**Yüksekliği**  
(Piston - Block  
Assembly Height)

**Kol Yatak**  
(Connecting Rod Bearing)

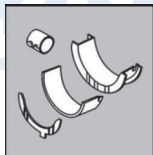

71-3850 STD

