



FORD LKW - Ø 115

87-72801-STD



**Motor Özellikleri**  
(Engine Specifications)

İmalatçı (Manufacturer):  
FORD LKW  
Çap (Diameter): Ø 115  
FM Grup No: 3133

**NHDD 9.0L Euro 6**  
6 Sil. Dizel 8974cc  
243 kW  
1833-2533-2633-3233  
2015....

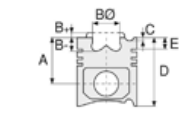

**Piston Ölçüleri**  
(Piston Dimensions)

A : 71.000  
B- : 18.700  
BØ : 82.000  
C1 : 1.800  
D : 116.500  
E : 10.220

Pim: 48 x 91,5



**Piston Özellikleri**  
(Piston Features)

Segman Taşıyıcı  
(Ring Carrier)  
Soğutma Kanallı  
(Coolin Gallery)  
Yağ Püskürtme Oyuğu  
(Oil Jet Cut-out)  
Gözarası Konik  
(Conical Eye Gap)

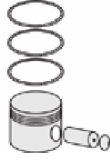

**Piston Parça No**  
(Piston Part No)

87-800500-02  
87-72801-STD



**Segman Seti**  
(Ring Set)

06-800500-00-STD

2.500  CKS KV4  
2.000  P F14  
3.000  CRP GOE



**Silindir Gömleği**  
(Liner)

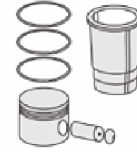

**Silindir Kit**  
(Assembly Set)

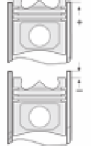

**Piston - Blok Montaj**  
Yüksekliği  
(Piston - Block  
Assembly Height)

**Ana Yatak**  
(Main Bearing)

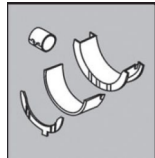

BM6016-0-GL

**Kol Yatak**  
(Connecting Rod Bearing)

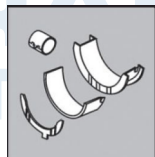

BC6019-0-GL

