



MAN - Ø 120

87-72955-STD



**Motor Özellikleri**  
(Engine Specifications)

İmalatçı (Manufacturer):  
MAN  
Çap (Diameter): Ø 120  
FM Grup No: 59012

**D2066LF EURO 6**  
6 Sil. Dizel 10518cc  
265kW-360PS  
TGS Serisi  
2014....

**Piston Ölçüleri**  
(Piston Dimensions)

A : 76.800  
B- : 22.460  
BØ : 66.000  
C1 : 2.000  
C2 : 1.600  
D : 123.300  
E : 12.000

Pim: 52 x 96



**Piston Özellikleri**  
(Piston Features)

Segman Taşıyıcı  
(Ring Carrier)  
Soğutma Kanallı  
(Coolin Gallery)  
Burçlu Piston  
(Bushing Piston)  
Gözarası Konik  
(Conical Eye Gap)

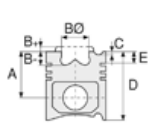

**Piston Parça No**  
(Piston Part No)

87-818100-02  
87-72955-STD



**Segman Seti**  
(Ring Set)

06-818100-00-STD

3.500 PVD ST  
2.500 NT ST  
3.500 NT ST

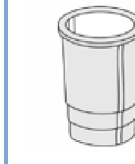

**Silindir Gömleği**  
(Liner)

14-451720-00-WH

B : 139.500  
L : 260.000  
D : 150.000  
C : 8.070

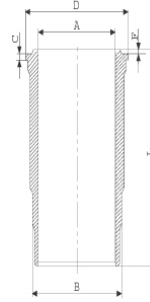

Kurum Giderme Ringli  
(With Soot Removal Ring)  
24-35054-00/0  
2X147, 50x139,  
50x4,75 FKM

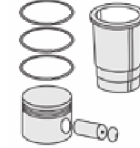

**Silindir Kit**  
(Assembly Set)

89-818100-02-STD  
89-72955-STD

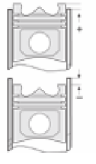

**Piston - Blok Montaj**  
Yüksekliği  
(Piston - Block  
Assembly Height)

**Ana Yatak**  
(Main Bearing)

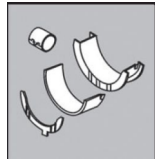

H1239/7 STD

**Kol Yatak**  
(Connecting Rod Bearing)

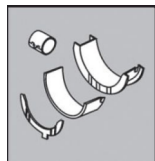

71-4529 STD/ 71-4746 STD

**Silindir Kapak Conta**  
(Cylinder Head Gasket)



30-026235-40

