



MAN - Ø 126

87-72961-STD



**Motor Özellikleri**  
(Engine Specifications)

İmalatçı (Manufacturer):  
MAN  
Çap (Diameter): Ø 126  
FM Grup No: 5489

**D 2676 LOH**  
**01-04/10/26-28**  
**Euro4/5**

6 Sil. Dizel 12419cc  
324-353 Kw  
(440-480 Ps)  
Cityliner, Lion's  
Coch L, Lion's Coch  
Supreme C, Lion's  
Coch Supreme L,  
Neoplan Skyliner,  
Starliner, Tourliner  
2006....

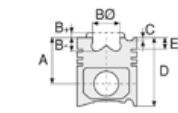

**Piston Ölçüleri**  
(Piston Dimensions)

A : 76.250  
B - : 20.000  
BØ : 70.900  
C1 : 2.000  
D : 121.840  
E : 12.600

Pim: 52 x 103



**Piston Özellikleri**  
(Piston Features)

Segman Taşıyıcı  
(Ring Carrier)  
Soğutma Kanallı  
(Coolin Gallery)  
Yağ Püskürtme Oyuğu  
(Oil Jet Cut-out)  
Burçlu Piston  
(Bushing Piston)  
Gözarası Konik  
(Conical Eye Gap)

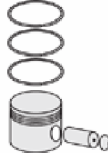

**Piston Parça No**  
(Piston Part No)

87-817700-22  
87-72961-STD



**Segman Seti**  
(Ring Set)

06-817700-20-STD  
4.000 GDC KV4  
3.000 CR GOE  
4.000 CR CR

Goetze® LKZ-Ring® /  
Yağ Segmanı Matkap  
Delikli (Oil Ring Drill  
Perforated)



**Silindir Gömleği**  
(Liner)

14-451040-00-WH  
B : 139.500  
L : 257.500  
D : 150.000  
C : 8.070

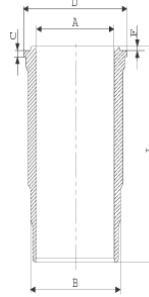

O-RING Bilgi (O-RING  
Information)  
24-35043-60/O  
2x 139,5\*3,95\*4,70 FPM

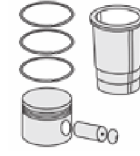

**Silindir Kit**  
(Assembly Set)

89-817700-22-STD  
89-72961-STD

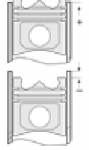

**Piston - Blok Montaj**  
Yüksekliği  
(Piston - Block  
Assembly Height)

14-451690-00-WH  
B : 139.500  
L : 257.500  
D : 150.000  
C : 8.570

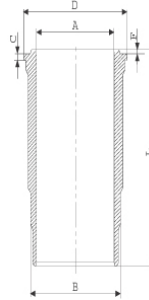

Flanş Kalınlığı ve Boğaz  
Çapı +0,50 mm Farklı  
(Flange Thickness and  
Throat Diameter +0.50  
mm Different)  
24-35043-60/O  
2x 139,5\*3,95\*4,70 FPM

14-451690-00-WH  
Flaş Kalınlığı ve Boğaz  
Çapı 0,50 mm Farklı  
(Flange Thickness and  
Throat Diameter 0.50  
mm Different)





MAN - Ø 126

87-72961-STD



**Motor Özellikleri**  
(Engine Specifications)

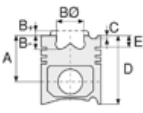

**Piston Ölçüleri**  
(Piston Dimensions)

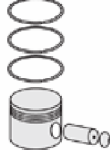

**Piston Parça No**  
(Piston Part No)



**Segman Seti**  
(Ring Set)



**Silindir Gömleği**  
(Liner)

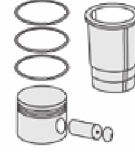

**Silindir Kit**  
(Assembly Set)

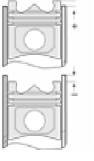

**Piston - Blok Montaj**  
**Yüksekliği**  
(Piston - Block  
Assembly Height)

**Ana Yatak**  
(Main Bearing)

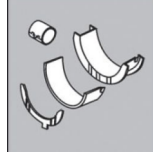

H1239/7 STD

**Kol Yatak**  
(Connecting Rod Bearing)

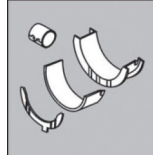

71-4529 STD

**Ay Yatak**  
(Thrust Washer)

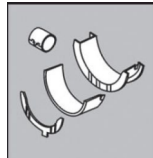

A159/4 STD

**Kol Burcu**  
(Small End Bushing)

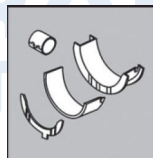

55-4563 SEMI

