



Motor Özellikleri
(Engine Specifications)

İmalatçı (Manufacturer):
SAAB SCANIA
Çap (Diameter): Ø 127
FM Grup No: 7577

DT12 O3 /11/12/17/19
6 Sil. Dizel
R 124 EURO 3
2006....

DT12/420 EURO 4
6 Sil. Dizel 420 PS
124
2009....

Piston Ölçüleri
(Piston Dimensions)

A : 85.210
B- : 22.450
BØ : 77.400
D : 122.710
E : 14.020

Pim: 54 x 106



Piston Özellikleri
(Piston Features)

Yağ Püskürtme Oyuğu
(Oil Jet Cut-out)
Gözarası Konik
(Conical Eye Gap)



Piston Parça No
(Piston Part No)

87-892600-02
87-75008-STD

87-892600-03
87-75008-STD1
0,20 mm Kısa (Short)

Çift parçalı Piston
(Articulated)



Segman Seti
(Ring Set)

06-892600-20-STD

3.500 CK KV1
2.385 CRP F14
3.500 CK GOE

Goetze® LKZ-Ring® /
Yağ Segmanı Matkap
Delikli (Goetze®
LKZ-Ring® / Oil Ring Drill
Perforated)



Silindir Gömleği
(Liner)

14-570030-00-WH
B : 140.000
L : 271.000
D : 151.000
C : 194.270
F : 0.970

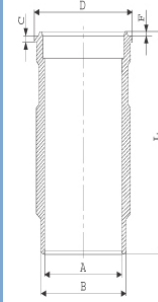

O-Ring Bilgi
(O-RING Information)
24-35046-60/O
1x 147,5*4 EPDM PEROX
1x 138*144,75*4.6 FPM

14-570050-00-WH
B : 138.500
L : 271.120
D : 150.000
C : 194,270
F : 0.800

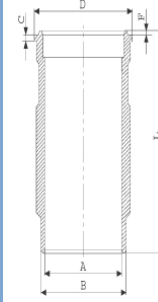

O-Ring Bilgi
(O-RING Information)
24-35054-60/O
1x 138*144,75*4.6 FPM
1x 148*4 FPM

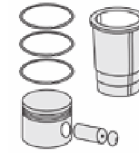

Silindir Kit
(Assembly Set)

89-892600-42
89-75008-STD8

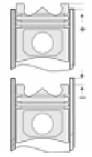

Piston - Blok Montaj
Yüksekliği
(Piston - Block
Assembly Height)



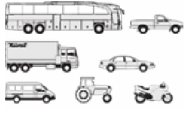

Motor Özellikleri
(Engine Specifications)

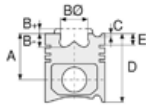

Piston Ölçüleri
(Piston Dimensions)



Piston Parça No
(Piston Part No)



Segman Seti
(Ring Set)



Silindir Gömleği
(Liner)

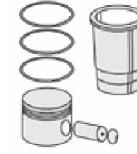

Silindir Kit
(Assembly Set)

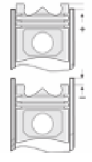

Piston - Blok Montaj
Yüksekliği
(Piston - Block
Assembly Height)

14-570050-00-WH
O-Ring Bilgi
(O-RING Information)
24-35042-60/O
1x138*144,75*4.6 FPM
1x 148*4 FPM

14-570030-00-WH
O-Ring Bilgi
(O-RING Information)
24-35046-60/O
1x 147,5*4 EPDM PEROX
1x138*144,75*4.6 FPM

14-570031-00-WH
B : 140.000
L : 271.000
D : 151.500
C : 194270.000
F : 970.000

Flanş Çapı +0,50 Farklı
Çalışması (Flange
Diameter +0,50
Different Study)

14-570032-00-WH
B : 140.000
L : 271.000
D : 152.000
C : 194270.000
F : 0.970

Flanş Çapı +1,00 Farklı
Çalışması (Flange
Diameter +1,00
Different Study)

15-570050-00-WH
B : 138.500
L : 271.120
D : 150.000
C : 5.000
F : 0.800

O-Ringli
(With O-Ring)





Motor Özellikleri
(Engine Specifications)

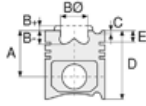

Piston Ölçüleri
(Piston Dimensions)

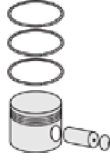

Piston Parça No
(Piston Part No)



Segman Seti
(Ring Set)



Silindir Gömleği
(Liner)

15-570030-00-WH
B : 140.000
L : 270.500
D : 150.960
C : 194.270
F : 0.970

O-Ringli
(With O-Ring)

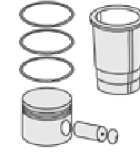

Silindir Kit
(Assembly Set)

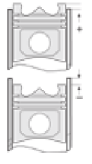

Piston - Blok Montaj
Yüksekliği
(Piston - Block
Assembly Height)

Ana Yatak
(Main Bed)

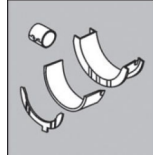

H1103/7 STD

72-4072 STD

Kol Yatak
(Connecting Rod Bearing)

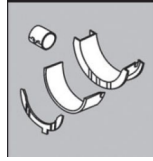

71-4860 STD

Ay Yatak
(Thrust Washer)

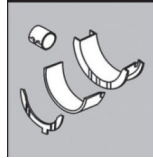

A232/4 STD

Eksantrik Yatak
(Camshaft Bearing)

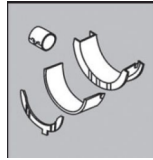

N173/7 STD

Kol Burcu
(Small End Bushing)

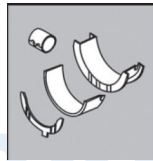

55-4544 SEMI

Sil. Kapak. Conta
(Cylinder Head Gasket)



AH5670

30-030491-00

