



KOMATSU - Ø 155

87-71357-STD



Motor Özellikleri
(Engine Specifications)

İmalatçı (Manufacturer):
KOMATSU
Çap (Diameter): Ø 155
FM Grup No: 4707

D155A
6 Sil. Dizel
6217-31-2030

1989---->

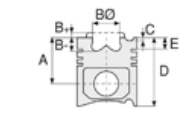

Piston Ölçüleri
(Piston Dimensions)

A : 102.500
B- : 16.000
BØ : 131.000
C1 : 7.500
D : 167.500
E : 23.200

Pim: 60 x 130



Piston Özellikleri
(Piston Features)

Segman Taşıyıcı
(Ring Carrier)
Gözarası Konik
(Conical Eye Gap)



Piston Parça No
(Piston Part No)

87-251800-02
87-71357-STD



Segman Seti
(Ring Set)

06-251800-10-STD
3.947 CRP KVI
3.947 CRP KVI
4.747 CRP STD



Silindir Gömleği
(Liner)

14-480610-00-WH
B : 176.000
L : 327.000
D : 185.700
C : 14.400
F : 1.200

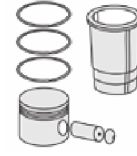
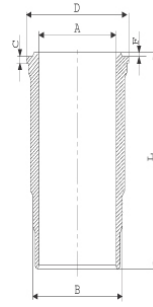

Silindir Kit
(Assembly Set)

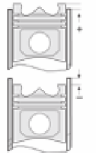

Piston - Blok Montaj
Yüksekliği
(Piston - Block
Assembly Height)

