

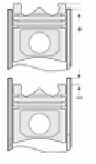

BMC - Ø 94

87-70412-STD

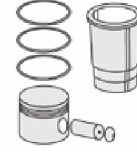
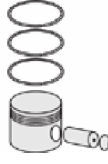
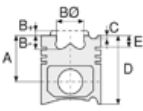

**Motor Özellikleri**  
(Engine Specifications)

İmalatçı (Manufacturer):  
BMC  
Çap (Diameter): 94  
FM Grup No: 1322

**2.8CRI C.RAIL**

4 Sil. Dizel 2776cc 82/95,6  
KW(110/130 BG)  
290M, 310P, 360P, 360V,  
360VH, 400P,  
MEGA STAR 290V  
2004...

**Piston Ölçüleri**  
(Piston Dimensions)

A : 52.100  
B- : 18.800  
BØ : 44.500  
C1 : 2.000  
D : 80.000  
E : 10.000

Pim: 32 x 74



**Piston Özellikleri**  
(Piston Features)

Segman Taşıyıcı  
(Ring Carrier)  
Soğutma Kanallı  
(Coolin Gallery)  
Yağ Püskürtme Oyuğu  
(Oil Jet Cut-out)  
Gözarası Konik  
(Conical Eye Gap)

**Piston Parça No**  
(Piston Part No)

87-846100-02  
87-70412-STD

**Segman Seti**  
(Ring Set)

06-846100-00-STD

2.500 CKP KV1  
1.500 P KV1  
2.000 P GOE

Goetze® LKZ-Ring® /  
Yağ segmanı matkap  
delikli (Oil Ring Drill  
Perforated)

**Silindir Gömleği**  
(Liner)

14-480340-00 WH  
B : 101.000  
L : 167.800  
D : 110.000  
C : 6.850  
F : 1.000

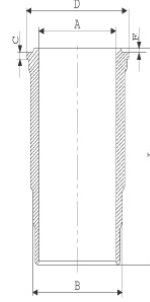

**Silindir Kit**  
(Assembly Set)

88-846100-02-STD  
88-70412-STD

**Piston - Blok Montaj**  
Yüksekliği  
(Piston - Block  
Assembly Height)

1,32 conta (Notch)  
+ 0,46 / + 0,60  
  
1,42 conta (Notch)  
1.Kertik + 0,62 / +0,70  
  
1,52 conta (Notch)  
2.Kertik +0,71 / + 0,80

