



FORD PKW - Ø 89,91

87-70891-STD



Motor Özellikleri
(Engine Specifications)

İmalatçı (Manufacturer):
FORD PKW
Çap (Diameter): 88,2
FM Grup No: 2925

HFFA, RBFA PUMA

DT24H Duratorq
4 Sil. Dizel 2402cc
88 Kw (120 PS) 19:1
Turbo Intercooled
TRANSIT FAE2 330S,
TRANSIT FAM,
TRANSIT FAO,
TRANSIT FAS,
TRANSIT FAT,
TRANSIT FGB2 KOMBI
280S, TRANSIT FGE2
KOMBI 330S, TRANSIT
FJD2 9 KİŞİLİK 300S,
TRANSIT FJE2 12 KİŞİLİK
330S, TRANSIT FLS VAN,
TRANSIT FMB2 KOMBI
VAN 280S, TRANSIT
FME2 KOMBI VAN 330S
2000 - 2003

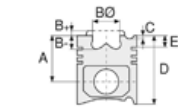

Piston Ölçüleri
(Piston Dimensions)

A : 53.500
B- : 17.240
BØ : 40.400
D : 80.500
E : 9.000

Pim: 32 x 71,1

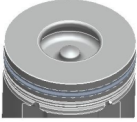

Piston Özellikleri
(Piston Features)

Segman Taşıyıcı
(Ring Carrier)
Soğutma Kanallı
(Coolin Gallery)
Gözarası Konik
(Conical Eye Gap)

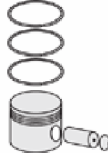

Piston Parça No
(Piston Part No)

87-113500-02
87-70891-STD
87-113505-02
87-70891 025

87-113507-02
87-70891 050

87-113500-12
87-70891-STD1
0,20 mm Kısa (Short)

87-113507-03
87-70891-0501
0,20 mm Kısa (Short)



Segman Seti
(Ring Set)

06-113500-00-STD
06-113505-00 0,25 mm
06-113507-00 0,50 mm

2.500 CKP KV1
2.000 P STD
3.000 CRP STD



Silindir Gömleği
(Liner)

14-020540-00-D
B : 92.500
L : 165.000
D : 95.500
C : 3.000

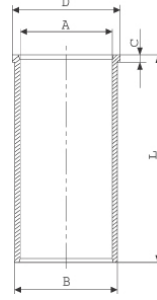

14-020541-00-D
B : 93.000
L : 165.000
D : 95.500
C : 3.300

Dış Çap 0,50mm Farklı
(Outer Diameter
0,50mm Different)

14-020542-00-D
B : 93.500
L : 165.000
D : 96.000
C : 4.000

Dış Çap 1,00mm Farklı
(Outer Diameter
1,00mm Different)

14-020910-00 D
B : 92.500
L : 165.000
D : 94.000
C : 5.000

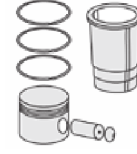

Silindir Kit
(Assembly Set)

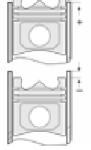

Piston - Blok Montaj
Yüksekliği
(Piston - Block
Assembly Height)

1,10 mm conta ile (With
Gasket)
+0,30 /+0,40

1,15 mm conta ile (With
Gasket)
+0,40/+0,45

1,20 mm conta ile (With
Gasket)
+0,45 /+0,50





FORD PKW - Ø 89,91

87-70891-STD



Motor Özellikleri
(Engine Specifications)

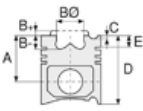

Piston Ölçüleri
(Piston Dimensions)

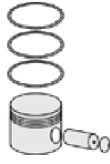

Piston Parça No
(Piston Part No)



Segman Seti
(Ring Set)



Silindir Gömleği
(Liner)

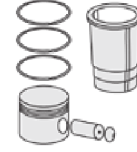

Silindir Kit
(Assembly Set)

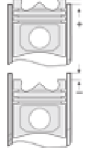

Piston - Blok Montaj
Yüksekliği
(Piston - Block
Assembly Height)

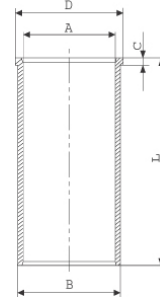

Flanş Çapı Küçük
(Small Flange Diameter)

14-020911-00 D

B : 93.000

L : 165.000

D : 94.500

C : 5.000

Dış Çap 0,50 mm Farklı
Yarı Mamul (Outside
Diameter 0.50 mm
Different Semi Products)

Ana Yatak
(Main Bearing)

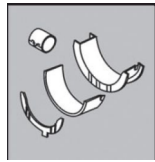

H1018/5 STD

Kol Yatak
(Connecting Rod Bearing)

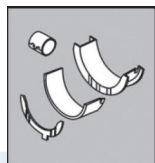

71-4066/4 STD

Sil. Kapak. Conta
(Cylinder Head Gasket)



AA5940

