



MERCEDES - Ø 132

87-75547-STD



Motor Özellikleri
(Engine Specifications)

İmalatçı (Manufacturer):
MERCEDES
Çap (Diameter): Ø 132
FM Grup No: 590138

OM 471 EURO 6
6 Sil. - Dizel 24 Valf
12809 cc / 12.8 l
310-390 kW / 422-539 PS
12809 cc / 12.8 l
Actros, Antos, Arocs,
İş Makinesi, Setra
2018--->

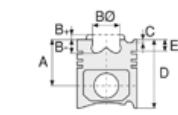

Piston Ölçüleri
(Piston Dimensions)

A : 75.000
B- : 14.950
BØ : 95.110
C1 : 1.500
D : 113.000
E : 10.000

Pim : 58 x 88



Piston Özellikleri
(Piston Features)

Soğutma Kanallı
(Coolin Gallery))
Gözarası Açılı
(Conical Eye Gap)



Piston Parça No
(Piston Part No)

87-440600-22
87-75547-STD
89-440600-22
89-75547-STD



Segman Seti
(Ring Set)

06-440600-20-STD
3.500 GDC ST
2.500 CKS KV4
3.500 CKS KV1

Goetze® LKZ-Ring®
Yağ Segmanı Matkap Delik
(Oil Ring Drill Hole)



Silindir Gömleği
(Liner)

15-610060-00-WH
B : 141.970
L : 256.000
D : 159.000
C : 7.000
R : 8.900

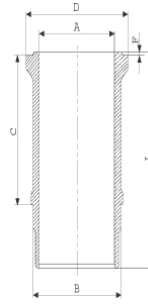

KURUM GİDERME
RİNGLİ VE O-RİNGLİ
(With Scraper Rings
And O-ring)
24-35053-00/0
1x 130*134*4.6 FKM 75
1x 146*153*3,9 FKM 75

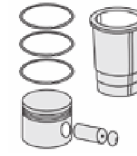

Silindir Kit
(Assembly Set)

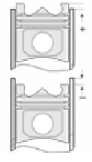

Piston - Blok Montaj
Yüksekliği
(Piston - Block
Assembly Height)

