



MAN - Ø 128

87-71537-STD



**Motor Özellikleri**  
(Engine Specifications)

İmalatçı (Manufacturer):  
MAN  
Çap (Diameter): Ø 128  
FM Grup No: 5500

**D 2876 LF 06/07**  
**EURO2**

6 Sil. Dizel 12816cc 460  
18.463 FLT TG-A,  
19.462 DL, 19.462 FLS,  
19.463, 19.464 TG-A 460,  
23.464, 26.464,  
FORTUNA MEGA  
2000....

**D 2876 LF 04, LOH**  
**O2/O3 EURO3**

6 Sil. Dizel 12816cc 460 hp  
18.463 TGA 460,  
19.464 TG-A 460,  
FORTUNA MEGA  
1995....

**Piston Ölçüleri**  
(Piston Dimensions)

A : 79.250  
B - : 21.740  
BØ : 85.280  
C1 : 1.900  
D : 134.250  
E : 18.700

Pim: 50 x 107

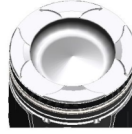

**Piston Özellikleri**  
(Piston Features)

Segman Taşıyıcı  
(Ring Carrier)  
Sert Anotlama  
(Hard Anodizing)  
Yağ Püskürtme Oyuğu  
(Oil Jet Cut-out)  
Gözarası Konik  
(Conical Eye Gap)

**Piston Parça No**  
(Piston Part No)

87-143800-92  
87-71537-STD  
87-143800-93  
87-71537-STD1  
0,20 mm Kısa (Short)  
87-143800-94  
87-71537-STD2  
0,40 mm Kısa (Short)  
87-143800-84  
87-71537-STD3  
0,60 mm Kısa (Short)

87-143800-20  
87-71537-STD B

**Segman Seti**  
(Ring Set)

06-143800-20-STD  
4.000 CK KV4  
3.000 CR GOE  
4.000 CR GOE  
Goetze® LKZ-Ring®

06-143800-40-STD  
4.000 CK KV4  
3.000 CR GOE  
4.000 CR GOE  
Goetze® LKZ-Ring®

**Silindir Gömleği**  
(Liner)

14-452920-00-WH  
B : 144.500  
L : 270.000  
D : 153.800  
C : 10.070  
F : 1.000

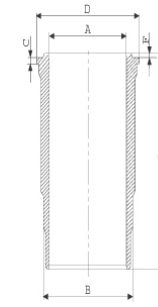

O-RING Bilgi  
(O-RING Information)  
24-32448-70/O  
2x 138\*2,1 FPM  
2x 144\*4 FPM

14-452930-00-WH  
B : 144.500  
L : 270.000  
D : 153.800  
C : 10.570  
F : 1.000

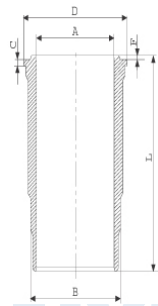

Flanş 0,50mm Farklı  
(Flange 0.50mm  
Different)

**Silindir Kit**  
(Assembly Set)

89-143800-92-STD  
89-71537-STD

**Piston - Blok Montaj**  
**Yüksekliği**  
(Piston - Block  
Assembly Height)

-0,01 / + 0,33





MAN - Ø 128

87-71537-STD



**Motor Özellikleri**  
(Engine Specifications)



**Piston Ölçüleri**  
(Piston Dimensions)



**Piston Parça No**  
(Piston Part No)



**Segman Seti**  
(Ring Set)



**Silindir Gömleği**  
(Liner)

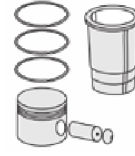

**Silindir Kit**  
(Assembly Set)



**Piston - Blok Montaj**  
**Yüksekliği**  
(Piston - Block  
Assembly Height)

**Ana Yatak**  
(Main Bearing)

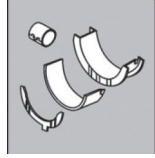

H1239/7 STD

H083/7 0.50MM

**Kol Yatak**  
(Connecting Rod Bearing)

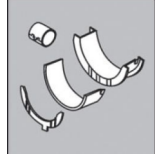

71-4746 STD

71-2965 STD

**Eksantrik Yatak**  
(Camshaft Bearing)

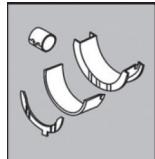

N109/7L STD

**Ay Yatak**  
(Thrust Washer)

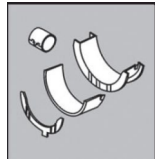

A159/4 STD

**Kol Burcu**  
(Small End Bushing)

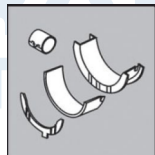

55-3813 SEMI

55-4832 SEMI (KONİK)

