



MAN - Ø 128

87-71577-STD A



**Motor Özellikleri**  
(Engine Specifications)

İmalatçı (Manufacturer):  
MAN  
Çap (Diameter): Ø 128  
FM Grup No: 5427

**D 2876 LF 02, LOH  
01 EURO2**

6 Sil. Dizel 12817cc  
338 Kw (460 PS) 17,1:1  
Turbo Intercooled 12 Valve  
19.462 FLS, 19.463 FLT,  
F 2000  
1995....

**Piston Ölçüleri**  
(Piston Dimensions)

A : 79.250  
B - : 23.100  
BØ : 81.280  
BX : 2.000  
C1 : 2.100  
D : 134.250  
E : 18.700

Pim: 50 x 107



**Piston Özellikleri**  
(Piston Features)

Segman Taşıyıcı  
(Ring Carrier)  
Yağ Püskürtme Oyuğu  
(Oil Jet Cut-out)  
Gözarası Konik  
(Conical Eye Gap)

**Piston Parça No**  
(Piston Part No)

87-124500-13  
87-71577-STD1C  
0,20 mm Kısa (Short)  
  
87-124500-14  
87-71577-STD2C  
0,40 mm Kısa (Short)  
  
87-124500-12  
87-71577-STD C

87-104300-02  
87-71577-STD A

**Segman Seti**  
(Ring Set)

06-124500-20-STD  
4.000 CK KV4  
3.000 GOE  
4.000 CR GOE  
  
Goetze® LKZ-Ring® /  
Yağ Segmanı Matkap  
Delikli (Oil Ring Drill  
Perforated)

06-104300-20-STD  
4.000 CK KV1  
3.000 STD  
4.000 CR STD  
  
Goetze® LKZ-Ring®

**Silindir Gömleği**  
(Liner)

14-452920-00-WH  
B : 144.500  
L : 270.000  
D : 153.800  
C : 10.070  
F : 1.000

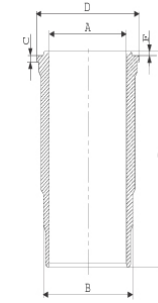

O-RING Bilgi  
(O-RING Information)  
24-32448-70/O  
2x 138\*2,1 FPM  
2x 144\*4 FPM

14-452920-00-WH  
O-RING Bilgi  
(O-RING Information)  
24-32448-70/O  
2x 138\*2,1 FPM  
2x 144\*4 FPM

14-452930-00-WH  
B : 144.500  
L : 270.000  
D : 153.800  
C : 10.570  
F : 1.000

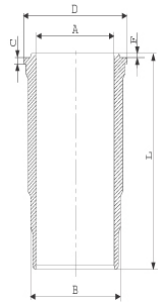

Flanş 0,50mm Farklı  
(Flange 0,50mm  
Different)

**Silindir Kit**  
(Assembly Set)

89-124500-12-STD  
89-71577-STD C

89-104300-02-STD  
89-71577-STD A

**Piston - Blok Montaj**  
Yüksekliği  
(Piston - Block  
Assembly Height)

+0,01 / +0,33

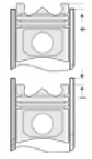



MAN - Ø 128

87-71577-STD A



**Motor Özellikleri**  
(Engine Specifications)



**Piston Ölçüleri**  
(Piston Dimensions)



**Piston Parça No**  
(Piston Part No)



**Segman Seti**  
(Ring Set)



**Silindir Gömleği**  
(Liner)

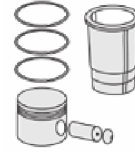

**Silindir Kit**  
(Assembly Set)



**Piston - Blok Montaj**  
Yüksekliği  
(Piston - Block  
Assembly Height)

**Ana Yatak**  
(Main Bearing)



H1239/7 STDH

992/7 STD

H9927 STD

**Kol Yatak**  
(Connecting Rod Bearing)

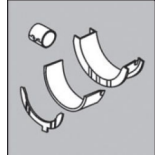

71-4746 STD

71-3812/6 STD

**Eksantrik Yatak**  
(Camshaft Bearing)

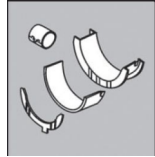

N109/7L STD

**Ay Yatak**  
(Thrust Washer)

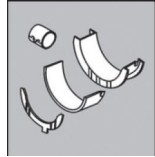

A159/4 STD

**Kol Burcu**  
(Small End Bushing)

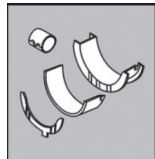

55-3813 SEMI

55-4832 SEMI

**Sil. Kapak. Conta**  
(Cylinder Head Gasket)



30-026235-30

BG850

