

Motor Özellikleri
(Engine Specifications)

İmalatçı (Manufacturer):
Saab-Scania
Çap (Diameter): 115
FM Grup No: 7564

DS9-01
6 Sil. Dizel 8471cc
162/180 KW (220/245)PS
TURBO
G82M, P82M, P92M
1985 - 1988

DS9-02
6 Sil. Dizel 8471cc
162/180 KW (220/245)PS
TURBO
G82M, P82M, P92M
1985 - 1988

DS9-01L01
6 Sil. Dizel 8471cc
180/202 KW (245/275 PS)
TURBO
G92H, G92M, P92H,
P92HB, P92M, P92MA,
R92H, R92M

DS9-01L02
6 Sil. Dizel 8471cc
180/202 KW (245/275 PS)
TURBO
G92H, G92M, P92H,
P92HB, P92M, P92MA,
R92H, R92M

DSC9-02
6 Sil. Dizel 8471cc
207 KW(282 PS)
TURBO INTERCOOLER
G92, G93, P92, P93ML,
R92, R93, T92
1985 - 1995

DS9-03B01
6 Sil. Dizel 8471cc
150 KW (204 PS)
TURBO
K92CL, K92CR, P93
1987 - 1997

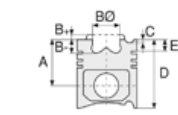

Piston Ölçüleri
(Piston Dimensions)

A : 87.400
B- : 22.150
BØ : 69.000
BX : 3.000
BY : 2.000
C1 : 2.600
C2 : 2.400
D : 139.400
E : 21.640

Pim: 50 x 92



Piston Özellikleri
(Piston Features)

Segman Taşıyıcı
(Ring Carrier)
Yağ Püskürtme Oyuğu
(Oil Jet Cut-out)
Gözarası Konik
(Conical Eye Gap)

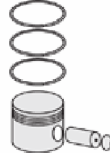

Piston Parça No
(Piston Part No)

87-960900-22
87-71893-STD



Segman Seti
(Ring Set)

06-960900-20-STD
3.160 CR KV1
2.385 STD
4.747 CR STD
Goetze® LKZ-Ring®



Silindir Gömleği
(Liner)

14-374990-00-WH
B : 130.000
L : 270.500
D : 137.300
C : 8.200
F : 0.800

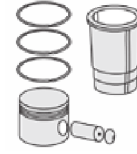
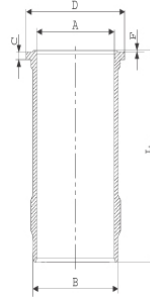

Silindir Kit
(Assembly Set)

88-960900-22-STD
88-71893-STD

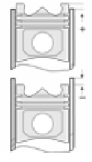

Piston - Blok Montaj
Yüksekliği
(Piston - Block
Assembly Height)

+0,07 / +0,50



SAAB - SCANIA - Ø 115

87-71893-STD



Motor Özellikleri
(Engine Specifications)

DS9-04
6 Sil. Dizel 8471cc
150 KW (204 PS)
TURBO
G82M, P82M

DS9-01L01
6 Sil. Dizel 8471cc
TURBO INTERCOOLED
G92H, G92M, P92H,
P92HB, P92M, P92MA,
R92H, R92M

DSC9-01L02
6 Sil. Dizel 8471cc
TURBO INTERCOOLED
G92H, G92M, P92H,
P92HB, P92M, P92MA,
R92H, R92M

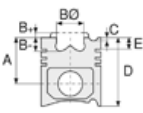

Piston Ölçüleri
(Piston Dimensions)

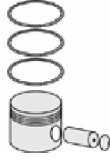

Piston Parça No
(Piston Part No)



Segman Seti
(Ring Set)



Silindir Gömleği
(Liner)

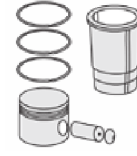

Silindir Kit
(Assembly Set)

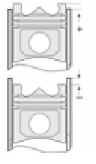

Piston - Blok Montaj
Yüksekliği
(Piston - Block
Assembly Height)

Ana Yatak
(Main Bearing)



H1073/7 STD

Kol Yatak
(Connecting Rod Bearing)

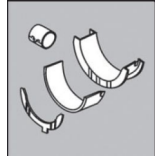

71-4214/6 STD

Ay Yatak
(Thrust Washer)

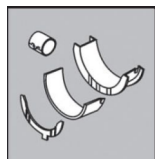

A271/4 STD

Sil. Kapak. Conta
(Cylinder Head Gasket)



HL605

