



Motor Özellikleri
(Engine Specifications)

İmalatçı (Manufacturer):
Scania
Çap (Diameter): 115
FM Grup No: 7558

DS8LB09 - LB14

6 Sil. Dizel 7800cc
140-148,5 Kw
(190-202 PS) 17:1
TURBO
K414, K414B, LB81, LB86,
LBS86
1975 - 1980

DS8LB09 - LB14

6 Sil. Dizel 7800cc
140-148,5 Kw
(190-202 PS) 17:1
TURBO
K414, K414B, LB81, LB86,
LBS86
1975 - 1980

DS801LB14/15/16

6 Sil. Dizel 7800cc
120 Kw (163 PS)
TURBO
K414, K414B, LB81, LB86,
LBS86
1975 - 1980

DS8-05

6 Sil. Dizel 7800cc
140Kw (190 PS)
TURBO
K414, K414B, P82H, P82M,
T82H, T82M
1981 - 1986

DS8-06L01

6 Sil. Dizel 7800cc
155Kw (211 PS)
TURBO
K414, K414B, P82H, P82M,
T82H, T82M
1981 - 1986

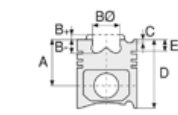

Piston Ölçüleri
(Piston Dimensions)

A : 96.110
B- : 18.100
BØ : 75.000
C1 : 2.500
D : 150.100
E : 21.200

Pim: 46 x 96

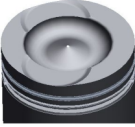

Piston Özellikleri
(Piston Features)

Segman Taşıyıcı
(Ring Carrier)
Gözarası Konik
Conical Eye Gap



Piston Parça No
(Piston Part No)

87-961000-02
87-71895-STD



Segman Seti
(Ring Set)

06-961000-80-STD
2.385 █ CKP IKA
2.385 █ STD
4.747 █ CR STD
Goetze® LKZ-Ring®



Silindir Gömleği
(Liner)

14-374990-00-WH
B : 130.000
L : 270.500
D : 137.300
C : 8.200
F : 0.800

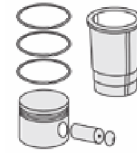
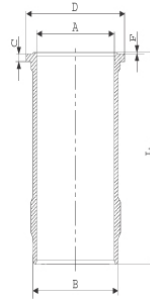

Silindir Kit
(Assembly Set)

88-961000-02-STD
88-71895-STD

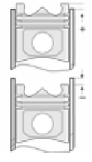

Piston - Blok Montaj
Yüksekliği
(Piston - Block
Assembly Height)

+0,07 / +0,50





SCANIA - Ø 115

87-71895-STD



Motor Özellikleri
(Engine Specifications)

DS18-01L01 - L04
6 Sil. Dizel 7800cc
170Kw (231 PS)
TURBO
P82H, P82M, T82H, T82M
1981 - 1986

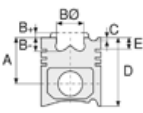

Piston Ölçüleri
(Piston Dimensions)

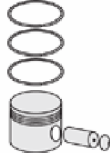

Piston Parça No
(Piston Part No)



Segman Seti
(Ring Set)



Silindir Gömleği
(Liner)

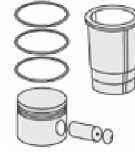

Silindir Kit
(Assembly Set)

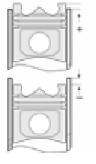

Piston - Blok Montaj
Yüksekliği
(Piston - Block
Assembly Height)

Ana Yatak
(Main Bearing)

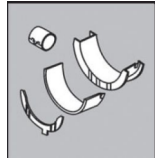

H987/7 STD

Kol Yatak
(Connecting Rod Bearing)

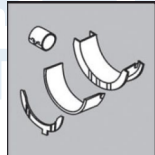

71-3191/6 STD

