



**Motor Özellikleri**  
(Engine Specifications)

İmalatçı (Manufacturer):  
Saab-Scania  
Çap (Diameter): 127  
FM Grup No: 7510

**DS 14 - DS 14.141 / 142**

8 Sil. Dizel 14200cc  
257 Kw (350 PS) 15:1  
Turbo  
L140, LB140, LBS140,  
LBT140, LS140, LT145  
1969 - 1976

**DS 14.01/02 DSI 14.01**

8 Sil. Dizel 14200cc  
309/316 Kw (420/430 PS)  
15,5:1  
Turbocharged Intercooled  
146, L141S, LB141S,  
LBS141S, LBT141S, LS141S,  
R142E, R142H, R142M,  
R142MA, T112E, T142H  
1983....

**DS 14.01/02 DSI 14.01**

8 Sil. Dizel 14200cc 3  
09/316 Kw (420/430 PS)  
15,5:1  
Turbocharged Intercooled  
146, L141S, LB141S,  
LBS141S, LBT141S, LS141S,  
R142E, R142H, R142M,  
R142MA, T112E, T142H  
1983....

**DS 14.06**

8 Sil. Dizel 14200cc  
276/291 Kw (375/396 PS)  
15,5:1  
Turbo  
141, 142, 146  
1977....

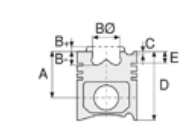

**Piston Ölçüleri**  
(Piston Dimensions)

A : 94.670  
B- : 26.200  
BØ : 75.500  
C1 : 2.920  
D : 145.670  
E : 23.330

Pim: 50 x 107,8

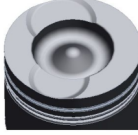

**Piston Özellikleri**  
(Piston Features)

Segman Taşıyıcı  
(Ring Carrier)  
Yağ Püskürtme Oyuğu  
(Oil Jet Cut-out)  
Gözarası Konik  
(Conical Eye Gap)



**Piston Parça No**  
(Piston Part No)

87-892400-02  
87-71905-STDA



**Segman Seti**  
(Ring Set)

06-892400-00-STD  
3.160 CK KV1  
2.385 CR STD  
4.747 CR STD  
Goetze® LKZ-Ring®



**Silindir Gömleği**  
(Liner)

14-671680-00-WH  
B : 140.000  
L : 276.000  
D : 156.000  
C : 10.100  
F : 0.400  
R : 21.500

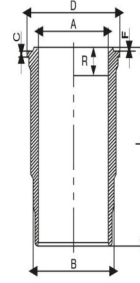

**O-RING BİLGİ (O-Ring Information)**

24-35047-90/0  
2x 140\*4 FPM 70  
1x 138\*143\*11  
1x 1X TOMBAC  
148,1\*153,7\*

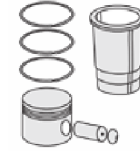

**Silindir Kit**  
(Assembly Set)

89-892400-02-STD  
89-71905-STDA

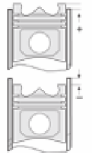

**Piston - Blok Montaj**  
Yüksekliği  
(Piston - Block  
Assembly Height)

87-892500-02  
87-73729-STDA

06-892500-00-STD  
3.500 CK KV1  
2.385 CR STD  
4.747 CR STD  
Goetze® LKZ-Ring®

114-671680-00 WH  
O-RİNG BİLGİ  
24-35047-90/0  
2x 140\*4 FPM 70  
1x 138\*143\*11  
1x 1X TOMBAC  
148,1\*153,7\*

89-892500-02-STD  
89-73729-STDA

87-962000-34  
87-73729-STDB

06-962000-20-STD  
3.500 CR KV1  
2.385 STD  
4.747 CR STD  
Goetze® LKZ-Ring®

14-671680-00 WH  
O-RİNG BİLGİ  
24-35047-90/0  
2x 140\*4 FPM 70  
1x 138\*143\*11  
1x 1X TOMBAC  
148,1\*153,7\*

89-962000-34-STD  
89-73729-STDB





**Motor Özellikleri**  
(Engine Specifications)

**DSC 14.01/02**  
8 Sil. Dizel 14181cc  
309/316 Kw (420/430 PS)  
15,5:1  
Turbocharged Intercooled  
146, L141S, LB141S,  
LBS141S, LBT141S, LS141S,  
R142E, R142H, R142M,  
R142MA, T112E, T142H  
1983....

**DSC 14.01/02**  
8 Sil. Dizel 14181cc  
309/316 Kw (420/430 PS)  
15,5:1  
Turbocharged Intercooled  
146, L141S, LB141S,  
LBS141S, LBT141S, LS141S,  
R142E, R142H, R142M,  
R142MA, T112E, T142H  
1983....

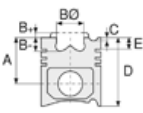

**Piston Ölçüleri**  
(Piston Dimensions)

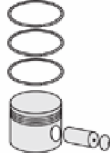

**Piston Parça No**  
(Piston Part No)



**Segman Seti**  
(Ring Set)



**Silindir Gömleği**  
(Liner)

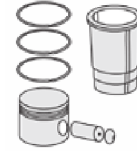

**Silindir Kit**  
(Assembly Set)

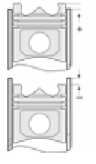

**Piston - Blok Montaj**  
Yüksekliği  
(Piston - Block  
Assembly Height)

**Ana Yatak**  
(Main Bearing)

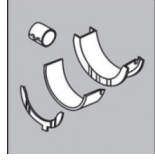

H1060/5 STD

**Kol Yatak**  
(Connecting Rod Bearing)

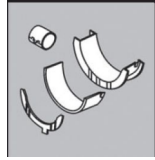

71-4249/8 STD

**Ay Yatak**  
(Thrust Washer)

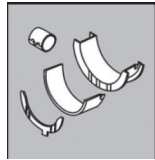

A216/4 STD

**Kol Burcu**  
(Small End Bushing)

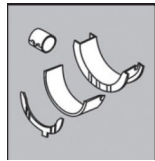

55-4240 SEMI

**Sil. Kapak. Conta**  
(Cylinder Head Gasket)



DB140

