

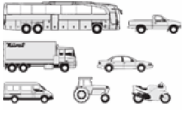

VOLVO - Ø 104,77

87-72207-STD A



Motor Özellikleri
(Engine Specifications)

İmalatçı (Manufacturer):
VOLVO
Çap (Diameter): Ø 104,775
FM Grup No: 8883

D7A,D7B
6 Sil. Dizel 6700cc 210
KW (285 PS) 18:1
FL 7-290
1995

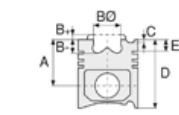

Piston Ölçüleri
(Piston Dimensions)

A : 88.550
B- : 20.250
BØ : 60.950
BX : 2.000
BY : 0.800
C1 : 2.100
C2 : 3.100
D : 132.550
E : 10.300

Pim : 45 x 82



Piston Özellikleri
(Piston Features)

Segman Taşıyıcı
(Ring Carrier)
Gözarası Konik
(Conical Eye Gap)



Piston Parça No
(Piston Part No)

87-832600-12
87-72207-STD A



Segman Seti
(Ring Set)

06-832600-20-STD
3.500 CK KV1
2.500 F14
3.500 CR STD
Goetze® LKZ-Ring®



Silindir Gömleği
(Liner)

14-450820-00-WH
B : 117.000
L : 256.800
D : 129.400
C : 9.400
F : 0.750

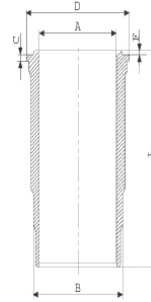

O-RİNG BİLGİ
(O-ring Information)
24-35030-50/0
2x 115,7*5,7 EPDM
PEROX 1x 115,7*5,7
FPM LILA 1x 114*1,6
FPM

14-450820-00-WH
O-Ring Bilgi
(O-ring Information)
24-35030-50/0
2x 115,7*5,7 EPDM
PEROX 1x 115,7*5,7
FPM LILA 1x 114*1,6
FPM

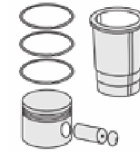

Silindir Kit
(Assembly Set)

88-832600-12-STD
88-72207-STD A

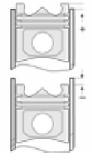

Piston - Blok Montaj
Yüksekliği
(Piston - Block
Assembly Height)





VOLVO - Ø 104,77

87-72207-STD A



Motor Özellikleri
(Engine Specifications)

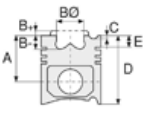

Piston Ölçüleri
(Piston Dimensions)

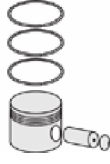

Piston Parça No
(Piston Part No)



Segman Seti
(Ring Set)



Silindir Gömleği
(Liner)

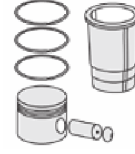

Silindir Kit
(Assembly Set)

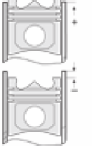

Piston - Blok Montaj
Yüksekliği
(Piston - Block
Assembly Height)

Ana Yatak
(Main Bearing)

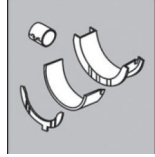

H1303/7 STD

H841/7 STD

Kol Yatak
(Connecting Rod Bearing)

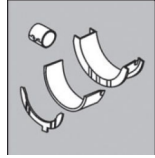

71-3623/6 STD

71-3964/6 STD

Kol Burcu
(Small End Bushing)

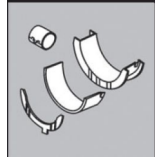

55-3965 SEMI

Silindir Kapak Conta
(Cylinder Head Gasket)



BT840

