



VOLVO - Ø 104,775

87-72209-STD



**Motor Özellikleri**  
(Engine Specifications)

İmalatçı (Manufacturer):  
VOLVO  
Çap (Diameter): Ø 104,775  
FM Grup No: 880101

**TAMD70**

6 Sil. Dizel 6724cc  
135-206 Kw (184-280 Ps)  
MARİNE MOTOR (Marine  
Engine)  
1974 - 1978

**TAMD 70 C**

6 Sil. Dizel 6724cc  
135-206 Kw (184-280 Ps)  
MARİNE MOTOR (Marine  
Engine)  
1974 - 1978

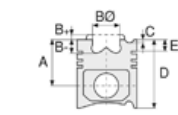

**Piston Ölçüleri**  
(Piston Dimensions)

A : 88.400  
B - : 26.600  
BØ : 61.400  
BX : 4.000  
D : 141.050  
E : 23.000

Pim : 45 x 85,72

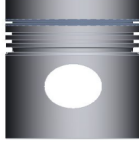

**Piston Özellikleri**  
(Piston Features)

Segman Taşıyıcı  
(Ring Carrier)  
Soğutma Kanallı  
(Cooling Gallery)  
Yağ Püskürtme Oyuğu  
(Oil Jet Cut-Out)  
Gözarası Düz  
(Flat Eye Gap)



**Piston Parça No**  
(Piston Part No)

87-407000-22  
87-72209-STD



**Segman Seti**  
(Ring Set)

06-407000-20-STD  
2.385 CR KV1  
3.160 STD  
3.160 STD  
4.747 CR STD  
Goetze® LKZ-Ring®



**Silindir Gömleği**  
(Liner)

14-451060-00-WH  
B : 117.000  
L : 257.000  
D : 126.986  
C : 11.660  
F : 0.740  
R : 18.350

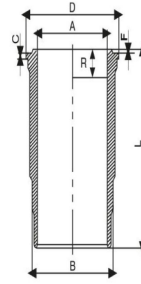

**Silindir Kit**  
(Assembly Set)

88-407000-22-STD  
88-72209-STD

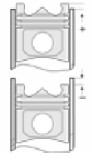

**Piston - Blok Montaj**  
Yüksekliği  
(Piston - Block  
Assembly Height)





VOLVO - Ø 104,775

87-72209-STD



**Motor Özellikleri**  
(Engine Specifications)

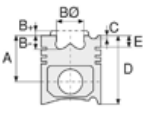

**Piston Ölçüleri**  
(Piston Dimensions)



**Piston Parça No**  
(Piston Part No)



**Segman Seti**  
(Ring Set)



**Silindir Gömleği**  
(Liner)

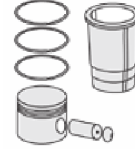

**Silindir Kit**  
(Assembly Set)

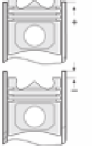

**Piston - Blok Montaj**  
**Yüksekliği**  
(Piston - Block  
Assembly Height)

**Ana Yatak**  
(Main Bearing)

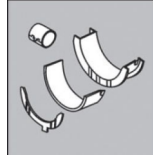

H841/7 STD

**Kol Yatak**  
(Connecting Rod Bearing)

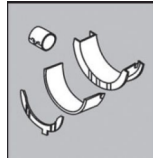

71-3480/6 STD

**Ay Yatak**  
(Thrust Washer)

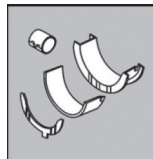

A126/4 STD

**Silindir Kapak Conta**  
(Cylinder Head Gasket)



EE220

