

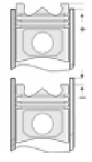

VOLVO - Ø 120,65

87-72224-STDA

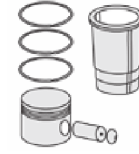
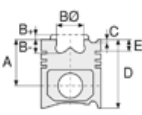
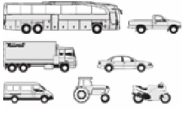

Motor Özellikleri
(Engine Specifications)

İmalatçı (Manufacturer):
VOLVO
Çap (Diameter): Ø 120,65
FM Grup No: 8819

TB 100 B
6 Sil. Dizel 9600cc
207-220 Kw(282-299 PS)
12,5:1
Turbo
F 10-38, F 10-46, F 10-49,
F 10-52, F 10-56, F10-20
1976 - 1981

Piston Ölçüleri
(Piston Dimensions)

A : 109.450
B - : 23.150
BØ : 75.900
BX : 4.000
C1 : 2.800
D : 166.450
E : 26.450

Pim: 52 x 106

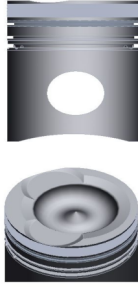

Piston Özellikleri
(Piston Features)

Segman Taşıyıcı
(Ring Carrier)
Gözarası Düz
(Flat Eye Gap)

Piston Parça No
(Piston Part No)

87-407100-52
87-72224-STDA

Segman Seti
(Ring Set)

06-407100-20-STD

2.385 CR KV1
3.160 CR STD
4.747 CR STD

Goetze® LKZ-Ring®

Silindir Gömleği
(Liner)

14-450520-00-WH

B : 134.000
L : 294.000
D : 147.000
C : 11.770
F : 0.780
R : 75.500

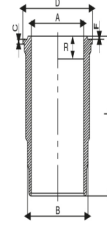

O-Ring Bilgi
(O-Ring Information)
1x 132,8*5,8 FPM LILA
1x 132,8*5,8 EPDM
1x 132,5*1,6 FPM

Silindir Kit
(Assembly Set)

89-407100-52-STD
89-72224-STDA

Piston - Blok Montaj
Yüksekliği
(Piston - Block
Assembly Height)

- 0,65 / + 0,15

87-407100-62
87-72224-STDB

06-407100-20-STD

2.385 CR KV1
3.160 CR STD
4.747 CR STD

Goetze® LKZ-Ring®

14-450320-00-WH

B : 134.000
L : 294.000
D : 147.000
C : 11.770
F : 0.780
R : 25.500

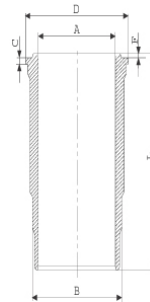

O-Ring Kanalı 3,70 mm
(O-Ring Groove
3.70 mm) / O-Ring Bilgi
(O-Ring Information)
24-35031-01/O
1x 132,8*5,8 FPM
1x 132,8*5,8 EPDM
1x 132,5*2,4 FPM





VOLVO - Ø 120,65

87-72224-STD A



Motor Özellikleri
(Engine Specifications)



Piston Ölçüleri
(Piston Dimensions)



Piston Parça No
(Piston Part No)



Segman Seti
(Ring Set)



Silindir Gömleği
(Liner)

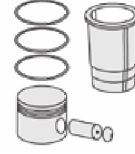

Silindir Kit
(Assembly Set)

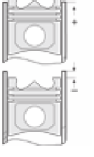

Piston - Blok Montaj
Yüksekliği
(Piston - Block
Assembly Height)

Ana Yatak
(Main Bearing)

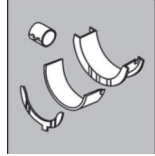

H842/7 STD

Kol Yatak
(Connecting Rod Bearing)

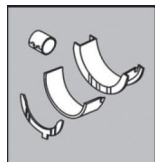

71-1227/6 STD

71-3601/6 STD

Ay Yatak
(Thrust Washer)

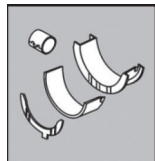

A122/4 STD

Kol Burcu
(Small End Bushing)

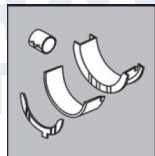

55-3509 SEMI



FEDERAL-MOGUL
POWERTRAIN
TÜRKİYE