

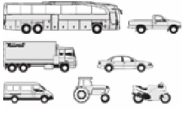

VOLVO - Ø 120,65

87-72225-STDC



Motor Özellikleri
(Engine Specifications)

İmalatçı (Manufacturer):
VOLVO
Çap (Diameter): Ø 120,65
FM Grup No: 8820

TD 100 A
6 Sil. Dizel 9600cc
169-191 Kw(230-260 PS)
17:1
Turbo
F 88, FB 88, N 10, N 88,
NB 88
1965 - 1975

THD 100 D/101 B/TMD
100 A/ 100 AK
6 Sil. Dizel 9600cc
169-191 Kw(230-260 PS)
15:1
Turbo
300 CH, 400 CH, B 10,
B 58, B 59
1975 - 1982

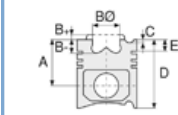

Piston Ölçüleri
(Piston Dimensions)

A : 109.450
B- : 27.650
BØ : 71.000
BX : 4.000
C1 : 1.000
C2 : 1.300
D : 166.450
E : 26.450

Pim: 52 x 106

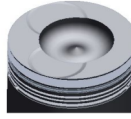
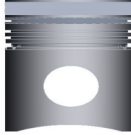

Piston Özellikleri
(Piston Features)

Segman Taşıyıcı
(Ring Carrier)
Gözarası Düz
(Flat Eye Gap)



Piston Parça No
(Piston Part No)

87-396300-12
87-72225-STDC



Segman Seti
(Ring Set)

06-396300-20-STD

2.385 CR KV1
3.160 IKA
3.160 STD
4.747 CR STD

Goetze® LKZ-Ring®



Silindir Gömleği
(Liner)

14-450520-00-WH
B : 134.000
L : 294.000
D : 147.000
C : 11.770
F : 0.780
R : 75.500

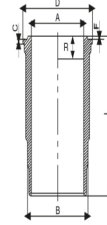

O-Ring Bilgi
(O-Ring Information)
24-35030-80/O
1x 132,8*5,8 FPM LILA
1x 132,8*5,8 EPDM
1x 132,5*1,6 FPM

14-450320-00-WH
B : 134.000
L : 294.000
D : 147.000
C : 11.770
F : 0.780
R : 25.500

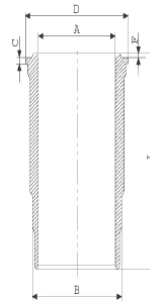

O-Ring Kanalı 3,70 mm
(O-Ring Groove
3.70 mm) / O-Ring Bilgi
(O-Ring Information)
24-35031-01/O
1x 132,8*5,8 FPM
1x 132,8*5,8 EPDM
1x 132,5*2,4 FPM

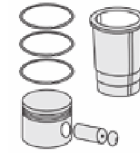

Silindir Kit
(Assembly Set)

89-396300-62-STD
89-72225-STDJ

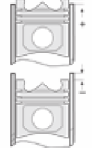

Piston - Blok Montaj
Yüksekliği
(Piston - Block
Assembly Height)

- 0,50 / + 0,20





VOLVO - Ø 120,65

87-72225-STDC



Motor Özellikleri
(Engine Specifications)

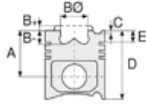

Piston Ölçüleri
(Piston Dimensions)



Piston Parça No
(Piston Part No)



Segman Seti
(Ring Set)



Silindir Gömleği
(Liner)

14-450780-00-WH
B : 134.000
L : 294.000
D : 147.000
C : 11.980
F : 0.620

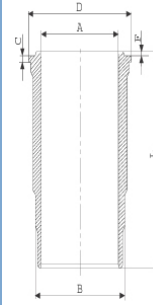

O-Ring Bilgi
(O-Ring Information)
24-35031-01/O
1x 132,8*5,8 FPM LILA
1x 132,8*5,8 EPDM
1x 132,5*2,4 FPM

14-450320-00-WH
O-Ring kanalı 3,70
mm / O-Ring Bilgi
(O-Ring Information)
24-35031-01/O
1x 132,8*5,8 FPM
1x 132,8*5,8 EPDM
1x 132,5*2,4 FPM

15-450320-00-WH
B : 134.000
L : 294.000
D : 147.000
C : 11.770
F : 0.780
R : 25.500

O-Ring Bilgi
(O-Ring Information) /
KANAL (3,70 mm)
4-35031-01/O
x 132,8*5,8 FPM
1x 132,8*5,8 EPDM
1x 132,5*2,4 FPM

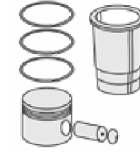

Silindir Kit
(Assembly Set)

89-396300-42-STD
89-72225-STDF

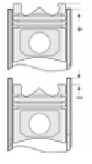

Piston - Blok Montaj
Yüksekliği
(Piston - Block
Assembly Height)



FEDERAL-MOGUL
POWERTRAIN



VOLVO - Ø 120,65

87-72225-STD



Motor Özellikleri
(Engine Specifications)

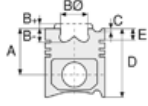

Piston Ölçüleri
(Piston Dimensions)

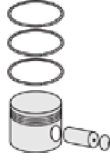

Piston Parça No
(Piston Part No)



Segman Seti
(Ring Set)



Silindir Gömleği
(Liner)

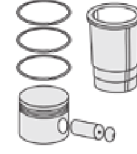

Silindir Kit
(Assembly Set)

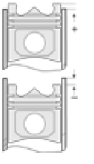

Piston - Blok Montaj
Yüksekliği
(Piston - Block
Assembly Height)

Ana Yatak
(Main Bearing)

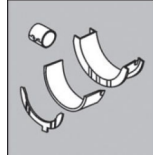

H842/7 STD

Kol Yatak
(Connecting Rod Bearing)

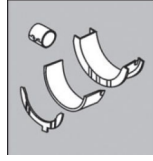

71-1227/6 STD

Eksantrik Yatak
(Camshaft Bearing)

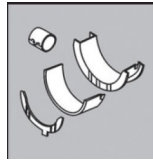

N157/7 STD

Ay Yatak
(Thrust Washer)

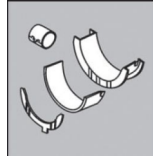

A122/4 STD

Kol Burcu
(Small End Bushing)

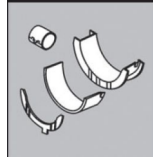

55-3509 SEMI

Silindir Kapak Conta
(Cylinder Head Gasket)



DE230

30-025262-11



FEDERAL-MOGUL
POWERTRAIN