

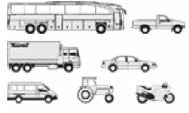

VOLVO - Ø 130,18

87-72229-STDA



**Motor Özellikleri**  
(Engine Specifications)

İmalatçı (Manufacturer):  
VOLVO  
Çap (Diameter): Ø 130,18  
FM Grup No: 8822

**TAMD 120 A / TD120 A**  
**/ TMD120 A**

6 Sil. Dizel 12000cc  
225-243 Kw(306-330 PS)

15:1

Turbo

CH 230, N 12  
1977 - 1981

**TD 120 A**

6 Sil. Dizel 12000cc  
243 Kw(330 PS) 15:1

Turbo

F 89, N 12  
1970 - 1975

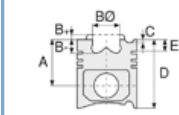

**Piston Ölçüleri**  
(Piston Dimensions)

A : 114.200  
B- : 31.550  
BØ : 75.000  
BX : 4.000  
C1 : 1.900  
C2 : 2.100  
D : 175.200  
E : 27.650

Pim: 55 x 114

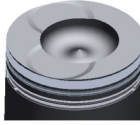

**Piston Özellikleri**  
(Piston Features)

Segman Taşıyıcı  
(Ring Carrier)  
Gözarası Düz  
(Flat Eye Gap)



**Piston Parça No**  
(Piston Part No)

87-405600-24  
87-72229-STD2A  
0,40 mm Kısa (Short)  
87-405600-04  
87-72229-STDA



**Segman Seti**  
(Ring Set)

06-405600-20-STD

2.385 CR KVI  
3.160 CR STD  
4.747 CR STD

Goetze® LKZ-Ring®



**Silindir Gömleği**  
(Liner)

14-450530-00-WH  
B : 144.000  
L : 311.000  
D : 157.600  
C : 13.520  
F : 0.760  
R : 18.000

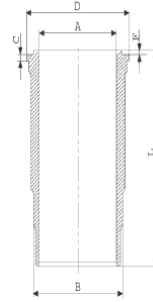

O-Ring Bilgi  
(O-Ring Information)  
24-35031-11/0  
1X142,8\*5,8 FPM  
1X142,8\*5,8 EPDM  
1X141\*2,4 FPM  
1X138?143\*11 NBR

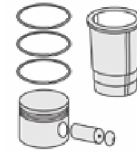

**Silindir Kit**  
(Assembly Set)

89-405600-04-STD  
89-72229-STDA

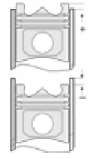

**Piston - Blok Montaj**  
**Yüksekliği**  
(Piston - Block  
Assembly Height)

- 0,05 / + 0,45





VOLVO - Ø 130,18

87-72229-STD A



**Motor Özellikleri**  
(Engine Specifications)



**Piston Ölçüleri**  
(Piston Dimensions)



**Piston Parça No**  
(Piston Part No)



**Segman Seti**  
(Ring Set)



**Silindir Gömleği**  
(Liner)

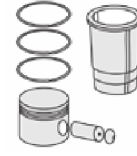

**Silindir Kit**  
(Assembly Set)



**Piston - Blok Montaj**  
**Yüksekliği**  
(Piston - Block  
Assembly Height)

**Ana Yatak**  
(Main Bearing)

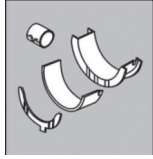

H1053/7 STD

**Kol Yatak**  
(Connecting Rod Bearing)

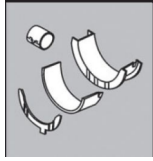

71-3613/6 STD

71-4236/6 STD

**Eksantrik Yatak**  
(Camshaft Bearing)

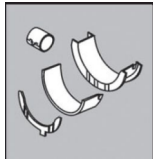

N157/7 STD

**Ay Yatak**  
(Thrust Washer)

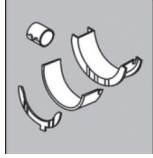

A131/4 STD

**Kol Burcu**  
(Small End Bushing)

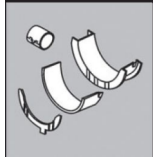

55-4509 SEMI

**Silindir Kapak Conta**  
(Cylinder Head Gasket)



DE240

30-024165-10

