



IVECO LKW - Ø 137

87-72888-STD A



Motor Özellikleri
(Engine Specifications)

İmalatçı (Manufacturer):
IVECO LKW
Çap (Diameter): 137
FM Grup No: 4208

8210.42.K

6 Sil. Dizel 13798cc
272 Kw (370 PS) 16:1
Turbocharge
190 E37 EUROTRAKKER,
260 E37 EUROTRAKKER,
340 E37 EUROTRAKKER,
380 E37 EUROTRAKKER,
400 E37 EUROTRAKKER,
410 E37 EUROTRAKKER,
440 E37 EUROTRAKKER,
720 E37 EUROTRAKKER
1996....

8210.42.K EURO2

6 Sil. Dizel 13798cc
309 Kw (420 PS) 16:1
Turbo Intercooled
180 E42 EUROTTECH,
190 E42 EUROSTAR,
190 E42 EUROTTECH,
190 E42 EUROTRAKKER,
240 E42 EUROTTECH,
260 E42 EUROTTECH,
260 E42 EUROTRAKKER,
380 E42 EUROTRAKKER,
400 E42 EUROSTAR,
400 E42 EUROTTECH,
440 E42 EUROSTAR,
440 E42 EUROTTECH,
440 E42 EUROTRAKKER
1996....

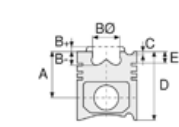

Piston Ölçüleri
(Piston Dimensions)

A : 92.000
B- : 25.450
BØ : 71.900
BX : 3.000
D : 157.000
E : 8.000

Pim: 50 x 115

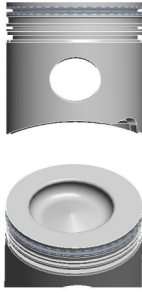

Piston Özellikleri
(Piston Features)

Segman Taşıyıcı
(Ring Carrier)
Soğutma Kanallı
(Coolin Gallery)
Yağ Püskürtme Oyuğu
(Oil Jet Cut-out)
Burçlu Piston
(Bushing Piston)
Gözarası Konik
(Conical Eye Gap)



Piston Parça No
(Piston Part No)

87-783000-53
87-72888-STD1A
0,20 mm Kısa (Short)
87-783000-52
87-72888-STD A



Segman Seti
(Ring Set)

06-783000-20 STD

4.000 CR KV1
3.000 CR IKA
5.500 CR STD

Goetze® LKZ-Ring®



Silindir Gömleği
(Liner)

14-020230-10-DH
B : 143.000
L : 282.000
D : 149.000
C : 6.000

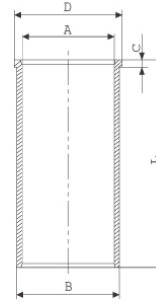

DIŞ YÜZEYİ FOSFAT
KAPLI (Outer Surface
Phosphate Coated)

14-020231-10-DH
B : 143.050
L : 282.000
D : 149.000
C : 6.000

DIŞ ÇAP 0,05 MM
FARKLI (Outer
Diameter 00,5mm
Different)

14-020232-10-DH
B : 143.250
L : 282.000
D : 149.000
C : 6.000

DIŞ ÇAP 0,25 MM
FARKLI -(Outer
Diameter 0,25mm
Different)

14-020233-10-DH
B : 143.500
L : 282.000
D : 149.000
C : 6.000

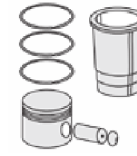

Silindir Kit
(Assembly Set)

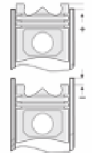

Piston - Blok Montaj
Yüksekliği
(Piston - Block
Assembly Height)

0,00 / 0,20





Motor Özellikleri
(Engine Specifications)



Piston Ölçüleri
(Piston Dimensions)

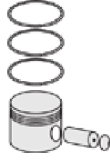

Piston Parça No
(Piston Part No)



Segman Seti
(Ring Set)



Silindir Gömleği
(Liner)

DIŞ ÇAP 0,50 MM
FARKLI (Outer Diameter
0,50mm Different) -
FOSFAT KAPLI
(Phosphate Coated)

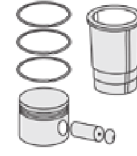

Silindir Kit
(Assembly Set)

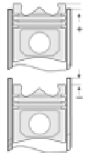

Piston - Blok Montaj
Yüksekliği
(Piston - Block
Assembly Height)

Ana Yatak
(Main Bearing)



H-1047/7-STD

Eksantrik Yatak
(Camshaft Bearing)

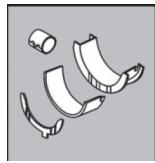

N174/4-STD

Kol Burcu
(Small End Bushing)

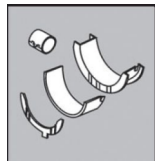

55-4107 SEMİ

Kol Yatak
(Connecting Rod Bearing)

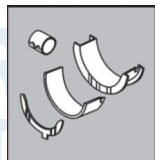

71-4383/6-STD

