

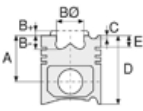

RVI - Ø 120

87-73831-STD



**Motor Özellikleri**  
(Engine Specifications)

İmalatçı (Manufacturer):  
RVI  
Çap (Diameter): 120  
FM Grup No: 7408

**MIDR O6.20.45D**  
6 Sil. Dizel 9839cc  
191/206 Kw (260/280 PS)  
16:1  
Turbo  
C290 6x4  
1986 - 1991

**Piston Ölçüleri**  
(Piston Dimensions)

A : 83.800  
B- : 23.250  
BØ : 69.850  
BX : 5.000  
C1 : 1.150  
C2 : 0.850  
D : 134.800  
E : 12.000

Pim: 49,975 x 97,4

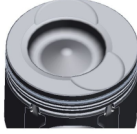

**Piston Özellikleri**  
(Piston Features)

Segman Taşıyıcı  
(Ring Carrier)  
Gözarası Düz  
(Flat Eye Gap)

**Piston Parça No**  
(Piston Part No)

87-886500-02  
87-73831-STD

**Segman Seti**  
(Ring Set)

06-886500-00-STD  
3.500 CK KV1  
3.000 IKA  
4.000 CR STD  
Goetze® LKZ-Ring®

**Silindir Gömleği**  
(Liner)

14-480020-00-WH  
B : 134.900  
L : 261.000  
D : 147.300  
C : 9.350  
F : 0.700

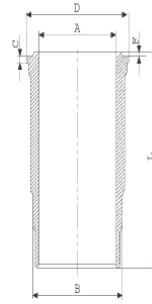

**O-RING BİLGİ (O-Ring**  
Information)  
24-35049-70/O  
2x 128\*2 FPM75 LILA  
2x 122\*4 FPM  
1x125X132,5X6.7 FPM

**Silindir Kit**  
(Assembly Set)

89-886500-02-STD  
89-73831-STD

**Piston - Blok Montaj**  
Yüksekliği  
(Piston - Block  
Assembly Height)





RVI - Ø 120

87-73831-STD



**Motor Özellikleri**  
(Engine Specifications)

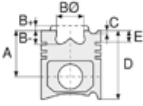

**Piston Ölçüleri**  
(Piston Dimensions)



**Piston Parça No**  
(Piston Part No)



**Segman Seti**  
(Ring Set)



**Silindir Gömleği**  
(Liner)

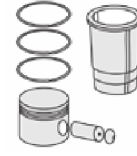

**Silindir Kit**  
(Assembly Set)



**Piston - Blok Montaj**  
**Yüksekliği**  
(Piston - Block  
Assembly Height)

**Ana Yatak**  
(Main Bearing)

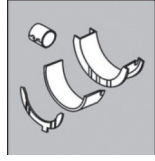

H1050/7 STD

H1129/7 STD

**Kol Yatak**  
(Connecting Rod Bearing)

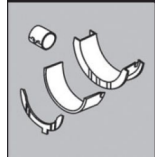

71-4290 STD

71-4295 STD

**Ay Yatak**  
(Thrust Washer)

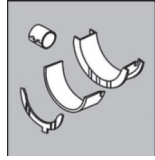

A207/4 STD

**Kol Burcu**  
(Small End Bushing)

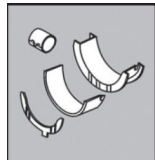

55-4296 SEMI

**Sil. Kapak. Conta**  
(Cylinder Head Gasket)



DG083

DW390

