



RVI - Ø 120

87-73832-STDA



Motor Özellikleri
(Engine Specifications)

İmalatçı (Manufacturer):
RVI
Çap (Diameter): 120
FM Grup No: 7409

MIDR O6.20.45
6 Sil. Dizel 9839cc 16:1
Turbo
1985....

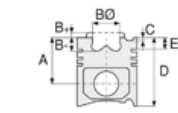

Piston Ölçüleri
(Piston Dimensions)

A : 83.800
B- : 22.600
BØ : 73.850
BX : 5.000
C1 : 1.000
D : 134.800
E : 12.000

Pim: 49,975 x 97,4



Piston Özellikleri
(Piston Features)

Segman Taşıyıcı
(Ring Carrier)
Gözarası Düz
(Flat Eye Gap)



Piston Parça No
(Piston Part No)

87-886600-12
87-73832-STDA



Segman Seti
(Ring Set)

06-886600-80-STD
3.000 CK KV1
3.000 CR STD
4.000 CR STD
Goetze® LKZ-Ring®



Silindir Gömleği
(Liner)

14-450190-00-WH
B : 134.910
L : 256.500
D : 147.500
C : 9.350
F : 0.700

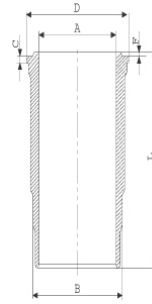

O-RING BİLGİ (O-Ring
Informations)
24-35044-60/O
1x 134,2*5,7 FPM
1x 134,2*5,7 FPM
2x 128*2 FPM

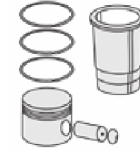

Silindir Kit
(Assembly Set)

89-886600-12-STD
89-73832-STDA

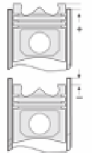

Piston - Blok Montaj
Yüksekliği
(Piston - Block
Assembly Height)





RVI - Ø 120

87-73832-STD A



Motor Özellikleri
(Engine Specifications)

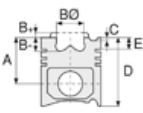

Piston Ölçüleri
(Piston Dimensions)

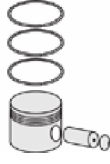

Piston Parça No
(Piston Part No)



Segman Seti
(Ring Set)



Silindir Gömleği
(Liner)

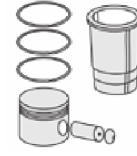

Silindir Kit
(Assembly Set)

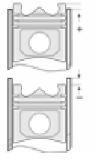

Piston - Blok Montaj
Yüksekliği
(Piston - Block
Assembly Height)

Ana Yatak
(Main Bearing)

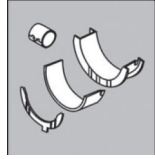

H1050/7 STD

H1129/7 STD

Kol Yatak
(Connecting Rod Bearing)

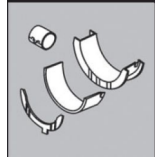

71-4290 STD

71-4295 STD

Ay Yatak
(Thrust Washer)

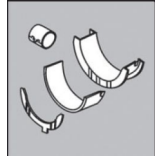

A207/4 STD

Kol Burcu
(Small End Bushing)

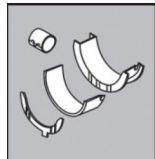

55-4296 SEMI

Sil. Kapak. Conta
(Cylinder Head Gasket)



DG083

DW390

