



MERCEDES BENZ LKW - Ø 85

87-72539-STDA



**Motor Özellikleri**  
(Engine Specifications)

İmalatçı (Manufacturer):  
MERCEDES BENZ LKW  
Çap (Diameter): Ø 85  
FM Grup No: 5998

**OM 457 LA EURO3**  
AXOR ÇEKİCİ (Axor Tractor)  
18.35 LS, AXOR ÇEKİCİ  
(Axor Tractor) 18.40 LS,  
HAVA KOMPRESÖRÜ  
(Air Compressor), O403

DC13 EURO6

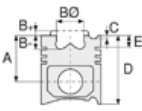

**Piston Ölçüleri**  
(Piston Dimensions)

A : 33.300  
D : 59.150  
E : 3.400

Pim : 19,05 x 60

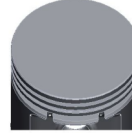

**Piston Özellikleri**  
(Piston Features)

Gözarası Düz  
(Flat Eye Gap)

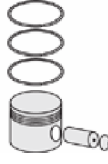

**Piston Parça No**  
(Piston Part No)

87-877100-12  
87-72539-STDA

87-877105-12  
87-72539-025A

87-877107-12  
87-72539-050A

87-877109-12  
87-72539-0,75A

87-877111-12  
87-72539-100A

87-741200-02  
87-72539-STDB

87-741207-02  
87-72539-0,50B



**Segman Seti**  
(Ring Set)

06-877100-20-STD  
06-877105-20-0,25 mm  
06-877107-20-0,50 mm  
06-877109-20-0,75 mm  
06-877111-20-1,00 mm

2.000 STD  
2.000 STD  
4.000 STD

06-741200-40-STD  
06-741207-40-0,50 mm

2.000 GOE  
2.000 GOE  
4.000 GOE



**Silindir Gömleği**  
(Liner)

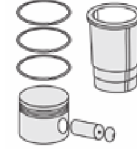

**Silindir Kit**  
(Assembly Set)

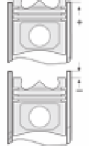

**Piston - Blok Montaj**  
Yüksekliği  
(Piston - Block  
Assembly Height)





MERCEDES BENZ LKW - Ø 85

87-72539-STDA



Motor Özellikleri  
(Engine Specifications)

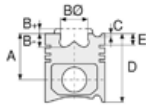

Piston Ölçüleri  
(Piston Dimensions)

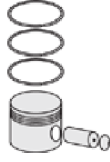

Piston Parça No  
(Piston Part No)



Segman Seti  
(Ring Set)



Silindir Gömleği  
(Liner)

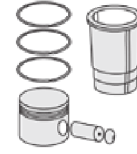

Silindir Kit  
(Assembly Set)

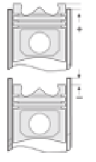

Piston - Blok Montaj  
Yüksekliği  
(Piston - Block  
Assembly Height)

Ana Yatak  
(Main Bearing)



H075/7 STD

Kol Yatak  
(Connecting Rod Bearing)



71-3893/6 STD

Eksantrik Yatak  
(Camshaft Bearing)

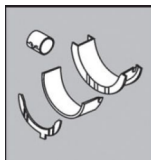

N205/7 SEMI

Kol Burcu  
(Small End Bushing)

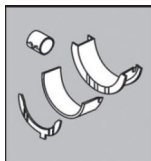

55-3328 SEMI

Sil. Kapak. Conta  
(Cylinder Head Gasket)



30-030171-00

