



IVECO LKW - Ø 104

87-70618-STD



Motor Özellikleri
(Engine Specifications)

İmalatçı (Manufacturer):
IVECO LKW
Çap (Diameter): Ø 104
FM Grup No: 4088

F4AFE411 A-B-C

Euro 6
4 Sil. Dizel 4485cc
118 KW-160 PS
FPT Nef4 EuroVI
137 Kw / Karsan ATAK
Sabit Mot-Endüstriyel
(Fixed Eng.-Industrial)

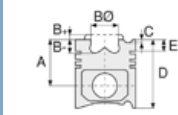

Piston Ölçüleri
(Piston Dimensions)

A : 62.700
B- : 20.000
BØ : 76.700
D : 96.400
E : 13.100

Pim: 40 x 87,5



Piston Özellikleri
(Piston Features)

Segman Taşıyıcı
(Ring Carrier)
Soğutma Kanallı
(Coolin Gallery)
Yağ Püskürtme Oyuğu
(Oil Jet Cut-out)
Gözarası Konik
(Conical Eye Gap)



Piston Parça No
(Piston Part No)

87-858200-02
87-70618-STD
87-858206-02
87-70618 0,40



Segman Seti
(Ring Set)

06-858200-00-STD
06-858206-00 0,40

3.000 CKS KVI
2.385 P GOE
4.000 CR GOE



Silindir Gömleği
(Liner)

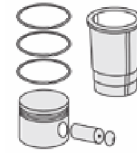

Silindir Kit
(Assembly Set)

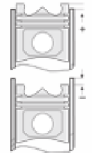

Piston - Blok Montaj
Yüksekliği
(Piston - Block
Assembly Height)

