



CUMMINS - BMC - Ø 107

87-73370-STD



Motor Özellikleri
(Engine Specifications)

İmalatçı (Manufacturer):
Cummins-BMC
Çap (Diameter): 107
FM Grup No: 2130

ISB 6.7 Euro 6
6 Sil. Dizel 209 KW
284PS / 280 HP
Procity 12M Otobus

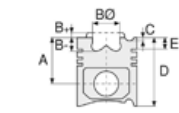

Piston Ölçüleri
(Piston Dimensions)

A : 69.300
B- : 18.300
BØ : 61.000
D : 103.100
E : 8.050

Pim: 40 x 90

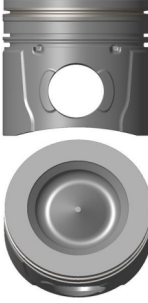

Piston Özellikleri
(Piston Features)

Segman Taşıyıcı
(Ring Carrier)
Soğutma Kanallı
(Coolin Gallery)
Yağ Püskürtme Oyuğu
(Oil Jet Cut-out)
Gözarası Konik
(Conical Eye Gap)

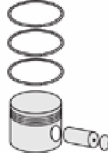

Piston Parça No
(Piston Part No)

87-821100-22
87-73370-STD
87-821107-22
87-73370-0,50



Segman Seti
(Ring Set)

06-821100-00-STD
06-821107-00 0,50 mm
3.000 CKS KV1
2.500 P F14
3.500 CR STD



Silindir Gömleği
(Liner)

14-011560-00-D
B : 109.802
L : 200.000

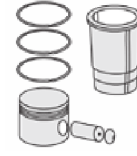
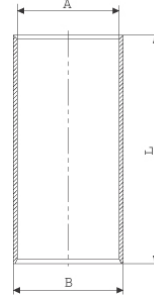

Silindir Kit
(Assembly Set)

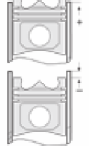

Piston - Blok Montaj
Yüksekliği
(Piston - Block
Assembly Height)

