



Motor Özellikleri
(Engine Specifications)

İmalatçı (Manufacturer):
MERCEDES BENZ LKW
Çap (Diameter): Ø 128
FM Grup No: 5958

**OM 355A.968/
969/978**

6 Sil. Dizel 11900cc
206/210 KW
(280/285 PS) 16,5:1
Turbo
1928, 2628, O 303
1978....

Piston Ölçüleri
(Piston Dimensions)

A : 90.260
B- : 28.500
BØ : 70.000
C1 : 2.000
C2 : 2.200
D : 161.060
E : 23.300

Pim: 48 x 108

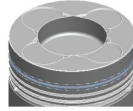

Piston Özellikleri
(Piston Features)

Segman Taşıyıcı
(Ring Carrier)
Gözarası Düz
(Flat Eye Gap)



Piston Parça No
(Piston Part No)

87-176900-32
87-70522-STDB

87-176907-32
87-70522 050B

87-176911-32
87-70522 100B

87-176914-32
87-70522 150B

87-176900-82
87-70522-STDC

87-176907-82
87-70522 0,50C



Segman Seti
(Ring Set)

06-176900-80-STD
06-176907-80 0,50 mm
06-176911-80 1,00 mm
06-176914-80 1,50 mm

3.500 CK KVI
3.500 GOE
3.500 GOE
6.500 CR GOE

Goetze® LKZ-Ring®

06-176900-40-STD
06-176907-40 0,50 mm
06-176911-40 1,00 mm
06-176914-40 1,50 mm

3.500 CK KVI
3.500 GOE
3.500 GOE
6.500 CR GOE

Goetze® LKZ-Ring®



Silindir Gömleği
(Liner)

14-025890-00-D
B : 133.565
L : 287.500
D : 137.500
C : 5.500

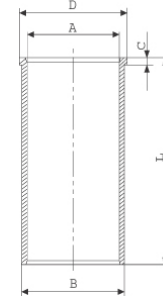

STD

14-025891-00-D
B : 134.065
L : 287.500
D : 138.000
C : 5.500

Dış Çap 0,50mm Farklı
(Outer Diameter
0,50 mm Different)

14-025892-00-D
B : 134.565
L : 287.500
D : 138.500
C : 5.500

Dış Çap 1,00mm Farklı
(Outer Diameter
1,00 mm Different)

14-025893-00-D
B : 135.065
L : 287.500
D : 139.000
C : 5.500

Dış Çap 1,50 mm Farklı
(Outer Diameter
1,50 mm Different)

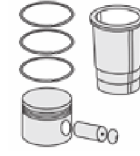

Silindir Kit
(Assembly Set)

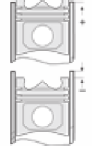

Piston - Blok Montaj
Yüksekliği
(Piston - Block
Assembly Height)

- 0,10 / + 0,22





MERCEDES BENZ LKW - Ø 128

87-70522-STD B

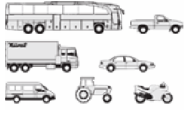

Motor Özellikleri
(Engine Specifications)

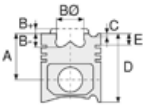

Piston Ölçüleri
(Piston Dimensions)

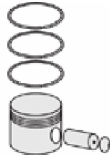

Piston Parça No
(Piston Part No)



Segman Seti
(Ring Set)



Silindir Gömleği
(Liner)

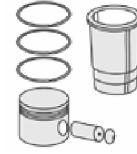

Silindir Kit
(Assembly Set)

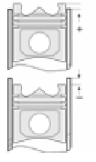

Piston - Blok Montaj
Yüksekliği
(Piston - Block
Assembly Height)

ANA YATAK
(MAIN BEARING)

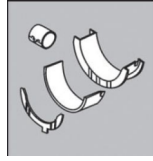

H818/7 STD

KOL YATAK
(ARM BED)

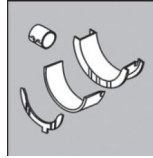

71-3004 STD

71-2549/6 STD

EKSANTRİK YATAK
(ECCENTRIC BEARING)

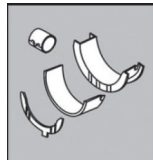

N082/7 SEMI

KOL BURCU
(SMALL END BUSH)

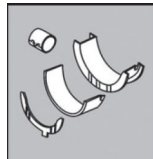

55-2538 SEMI

SİL. KAPAK. CONTA
(CYLINDER HEAD GASKET)



30-021834-30

AS450

