



**Motor Özellikleri**  
(Engine Specifications)

İmalatçı (Manufacturer):  
MASSEY FERGUSON  
Çap (Diameter): Ø 91,48  
FM Grup No: 5601

**A 3.152**

3 Sil. Dizel 2500cc  
27/31 Kw (37/42 PS) 17,4:1  
Etekte Segman Var  
(There Is a Segment  
In The Skirt)  
1972 - 2000

**A 4.203**

4 Sil. Dizel 3335cc  
41 Kw (56 PS) 17,4:1  
Etekte Segman Var  
(There Is a Segment  
In The Skirt)  
TRAKTOR MF 35/65  
1962 - 1988

**Piston Ölçüleri**  
(Piston Dimensions)

A : 57.200  
D : 107.900  
E : 13.800

Pim: 31,75 x 75,3

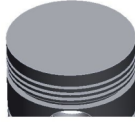

**Piston Özellikleri**  
(Piston Features)

Gözarası Düz  
(Flat Eye Gap)

**Piston Parça No**  
(Piston Part No)

87-314600-02  
87-71729-STD A

87-314600-22  
87-71729-STD B

**Segman Seti**  
(Ring Set)

06-314600-20-STD

2.385 CRP KVI  
2.385 P GOE  
3.160 P GOE  
6.350 CRP GOE  
6.350 P GOE

06-314600-50-STD

2.385 CRP IKA  
2.385 P GOE  
3.160 P GOE  
6.350 ST  
6.350 P STD

**Silindir Gömleği**  
(Liner)

14-025830-00-D

B : 93.810  
L : 216.000  
D : 96.660  
C : 5.000

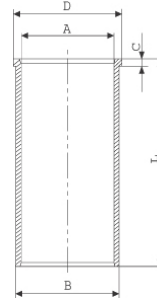

14-025831-10-D

B : 94.310  
L : 216.000  
D : 96.660  
C : 6.000

Dış Çap 0,50mm Farklı  
(Outer Diameter  
0,50 mm Different)

14-025832-10-D

B : 94.810  
L : 216.000  
D : 97.660  
C : 6.000

Dış Çap 1,00mm Farklı  
(Outer Diameter  
1,00 mm Different)

14-025833-10-D

B : 95.310  
L : 216.000  
D : 98.160  
C : 6.250

Dış Çap 1,50mm Farklı  
(Outer Diameter  
1,50 mm Different)

**Silindir Kit**  
(Assembly Set)

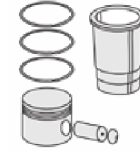

**Piston - Blok Montaj**  
Yüksekliği  
(Piston - Block  
Assembly Height)

- 0,13 / 0

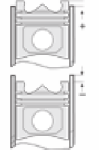



MASSEY FERGUSON - Ø 91,48

87-71729-STDA



**Motor Özellikleri**  
(Engine Specifications)

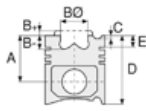

**Piston Ölçüleri**  
(Piston Dimensions)



**Piston Parça No**  
(Piston Part No)



**Segman Seti**  
(Ring Set)



**Silindir Gömleği**  
(Liner)

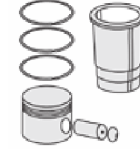

**Silindir Kit**  
(Assembly Set)

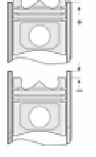

**Piston - Blok Montaj**  
**Yüksekliği**  
(Piston - Block  
Assembly Height)

14-025834-10-D  
B : 95.810  
L : 216.000  
D : 98.660  
C : 6.500

Dış Çap 1,20mm Farklı  
(Outer Diameter  
1,20 mm Different)

14-026450-00-D  
B : 93.820  
L : 216.000  
D : 96.950  
C : 5.000

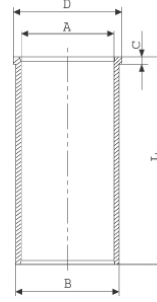

Geniş Flanşlı  
(Wide Flange)

14-026451-10-D  
B : 93.820  
L : 216.000  
D : 96.950  
C : 5.500

Dış Çap 0,50mm Farklı  
(Outer Diameter  
0,50 mm Different)

14-026452-10-D  
B : 94.820  
L : 216.000  
D : 97.950  
C : 6.000

Dış Çap 1,00mm Farklı  
(Outer Diameter  
1,00 mm Different)





**Motor Özellikleri**  
(Engine Specifications)

İmalatçı (Manufacturer):  
MASSEY FERGUSON  
Çap (Diameter): Ø 95  
FM Grup No: 5615

**SJ 327E**  
3 Sil. Dizel 50-58 HP  
MF 240S, MF 2615,  
MF 2620  
2013....

**Piston Ölçüleri**  
(Piston Dimensions)

A : 61.750  
B- : 22.500  
BØ : 47.750  
BX : 4.200  
BY : 1.050  
C1 : 1.600  
D : 99.800  
E : 9.500

Pim: 31,75 x 67,8



**Piston Özellikleri**  
(Piston Features)

Segman Taşıyıcı  
(Ring Carrier)  
Gözarası Konik  
(Conical Eye Gap)

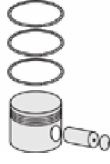

**Piston Parça No**  
(Piston Part No)

87-882000-02  
87-73251-STD



**Segman Seti**  
(Ring Set)

06-882000-00-STD

3.000 CR KV1  
2.000 P F14  
4.000 CR GOE



**Silindir Gömleği**  
(Liner)

14-022380-00-D

B : 98.000  
L : 216.000  
D : 102.600  
C : 4.000

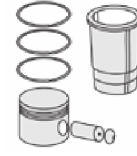
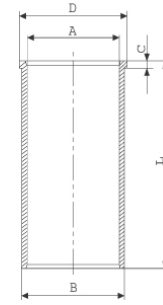

**Silindir Kit**  
(Assembly Set)

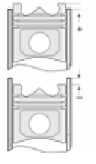

**Piston - Blok Montaj**  
Yüksekliği  
(Piston - Block  
Assembly Height)

0,150 / 0,160





**Motor Özellikleri**  
(Engine Specifications)

İmalatçı (Manufacturer):  
VOLVO-MASSEY  
FERGUSON  
Çap (Diameter): Ø 98,48  
FM Grup No: 5603

AD 4.236  
4 Sil. Dizel 3846cc 43,5/59  
Kw (59/80 PS) 16:1  
SERIE MF 87/95/99/  
175/177/187/  
1965 - 1982

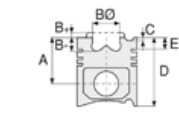

**Piston Ölçüleri**  
(Piston Dimensions)

A : 70.680  
B - : 20.710  
BØ : 61.000  
BX : 3.180  
D : 121.480  
E : 21.450

Pim : 34,925 x 84,1

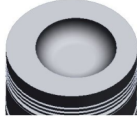

**Piston Özellikleri**  
(Piston Features)

Gözarası Düz  
(Flat Eye Gap)

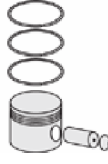

**Piston Parça No**  
(Piston Part No)

87-315007-22  
87-71736-050  
87-315000-22  
87-71736-STD  
87-315000-23  
87-71736-STD1  
0,43 mm Kısa (Short)  
87-315000-24  
87-71736-STD2  
0,20 mm Kısa (Short)



**Segman Seti**  
(Ring Set)

06-315000-10-STD  
06-315007-10-0,50 mm  
2.385 CRP KV1  
2.385 P STD  
2.385 P STD  
6.355 CRP STD  
6.335 P STD



**Silindir Gömleği**  
(Liner)

14-021980-00-D  
B : 104.280  
L : 226.440  
D : 107.380  
C : 3.800

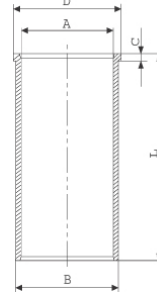

14-021981-00-D  
B : 104.780  
L : 226.440  
D : 107.400  
C : 4.000

Dış Çap 0,50 mm. farklı  
(Outside Diameter  
0.50mm Different)

14-021982-00-D  
B : 105.280  
L : 226.440  
D : 107.420  
C : 4.250

Dış Çap 1,00 mm. farklı  
(Outside Diameter  
1.00mm Different)

14-045820-10-D  
B : 103.330  
L : 227.280  
D : 106.420  
C : 3.800  
F : 0.900

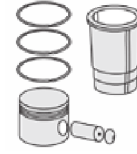

**Silindir Kit**  
(Assembly Set)

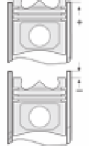

**Piston - Blok Montaj**  
Yüksekliği  
(Piston - Block  
Assembly Height)

+0,38 / +0,53





**Motor Özellikleri**  
(Engine Specifications)

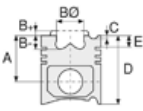

**Piston Ölçüleri**  
(Piston Dimensions)

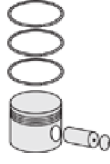

**Piston Parça No**  
(Piston Part No)



**Segman Seti**  
(Ring Set)



**Silindir Gömleği**  
(Liner)

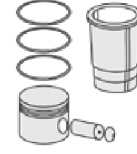

**Silindir Kit**  
(Assembly Set)

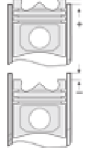

**Piston - Blok Montaj**  
Yüksekliği  
(Piston - Block  
Assembly Height)

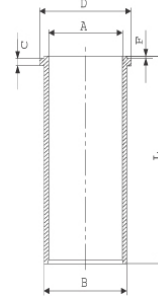

14-045821-10-D  
B : 103.830  
L : 227.280  
D : 106.920  
C : 4.300  
F : 0.900

Dış Çap 0,50 mm. farklı  
(Outside Diameter  
0.50mm Different)

14-045822-10-D  
B : 104.330  
L : 227.280  
D : 107.420  
C : 4.800  
F : 0.900

Dış Çap 1,00 mm. farklı  
(Outside Diameter  
1.00mm Different)

14-045823-10-D  
B : 104.830  
L : 227.280  
D : 107.920  
C : 5.300  
F : 0.900





MASSEY FERGUSON - Ø 98,48

87-71738-STD



**Motor Özellikleri**  
(Engine Specifications)

İmalatçı (Manufacturer):  
MASSEY FERGUSON  
Çap (Diameter): Ø 98,48  
FM Grup No: 5605

**A 6.354.4**

6 Sil. Dizel 5794cc  
67-84 Kw (91-118 PS) 16:1  
24.530, MF 24/33/82/  
85/95, MF 2625/2640/  
2645/2670/2675/30,  
MF 399/520/530/542/  
550, MF 90/95/1100/  
1114/1200/2620  
1971 - 1989

**Piston Ölçüleri**  
(Piston Dimensions)

A : 70.500  
B - : 26.050  
BØ : 54.100  
BX : 3.200  
D : 121.300  
E : 21.600

Pim: 34,925 x 84,1

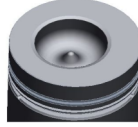

**Piston Özellikleri**  
(Piston Features)

Segman Taşıyıcı  
(Ring Carrier)  
Çelik Plaka  
(Steel Strut)  
Gözarası Düz  
(Flat Eye Gap)

**Piston Parça No**  
(Piston Part No)

87-318900-22  
87-71738-STD  
87-318900-23  
87-71738-STD1  
0,58 mm Kısa (Short)

**Segman Seti**  
(Ring Set)

06-318900-10-STD  
2.385 CRP KVI  
2.385 P STD  
4.747 CRP STD



**Silindir Gömleği**  
(Liner)

14-021980-00-D  
B : 104.280  
L : 226.440  
D : 107.380  
C : 3.800

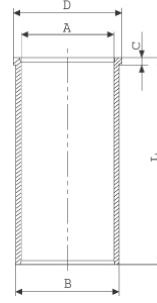

14-021981-00-D  
B : 104.780  
L : 226.440  
D : 107.400  
C : 4.000

Dış Çap 0,50 mm Farklı  
(Outer Diameter  
0,50 mm Different)

14-021982-00-D  
B : 105.280  
L : 226.440  
D : 107.420  
C : 4.250

Dış Çap 1,00 mm Farklı  
(Outer Diameter  
1,00 mm Different)

14-045820-10-D  
B : 103.330  
L : 227.280  
D : 106.420  
C : 3.800  
F : 0.900

**Silindir Kit**  
(Assembly Set)

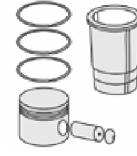

**Piston - Blok Montaj**  
Yüksekliği  
(Piston - Block  
Assembly Height)

0 / + 0,18

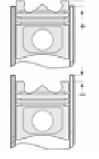



**Motor Özellikleri**  
(Engine Specifications)

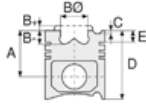

**Piston Ölçüleri**  
(Piston Dimensions)

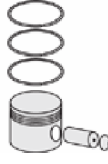

**Piston Parça No**  
(Piston Part No)



**Segman Seti**  
(Ring Set)



**Silindir Gömleği**  
(Liner)

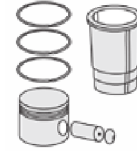

**Silindir Kit**  
(Assembly Set)

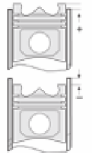

**Piston - Blok Montaj**  
**Yüksekliği**  
(Piston - Block  
Assembly Height)

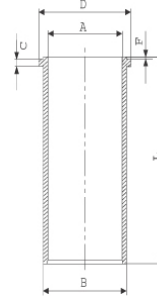

14-045821-10-D  
B : 103.830  
L : 227.280  
D : 106.920  
C : 4.300  
F : 0.900

Dış Çap 0,50mm Farklı  
(Outer Diameter  
0,50 mm Different)

14-045822-10-D  
B : 104.330  
L : 227.280  
D : 107.420  
C : 4.800  
F : 0.900

Dış Çap 1,00mm Farklı  
(Outer Diameter  
1,00 mm Different)

14-045823-10-D  
B : 104.830  
L : 227.280  
D : 107.920  
C : 5.300  
F : 0.900





MASSEY FERGUSON - Ø 98,48

87-71739-STD



**Motor Özellikleri**  
(Engine Specifications)

İmalatçı (Manufacturer):  
MASSEY FERGUSON  
Çap (Diameter): Ø 98,48  
FM Grup No: 5604

A 212

4 Sil. Dizel 3475cc  
44/47 Kw (60/64 PS) 16:1  
MF 50/50RA/165/  
186/R 7000  
1969....

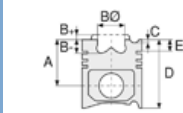

**Piston Ölçüleri**  
(Piston Dimensions)

A : 76.500  
B- : 19.200  
BØ : 59.600  
BX : 4.000  
D : 127.300  
E : 21.000

Pim: 34,925 x 84,1

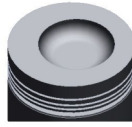

**Piston Özellikleri**  
(Piston Features)

Gözarası Düz  
(Flat Eye Gap)



**Piston Parça No**  
(Piston Part No)

87-883800-22  
87-71739-STD



**Segman Seti**  
(Ring Set)

06-883800-10-STD  
2.385 CRP KVI  
2.385 P STD  
2.385 P STD  
6.350 CRP STD



**Silindir Gömleği**  
(Liner)

14-021980-00-D  
B : 104.280  
L : 226.440  
D : 107.380  
C : 3.800

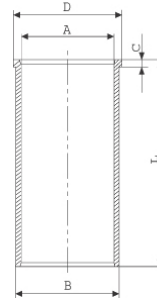

14-021981-00-D  
B : 104.780  
L : 226.440  
D : 107.400  
C : 4.000

Dış Çap 0,50 mm Farklı  
(Outer Diameter  
0,50 mm Different)

14-021982-00 D  
B : 105.280  
L : 226.440  
D : 107.420  
C : 4.250

Dış Çap 1,00 mm Farklı  
(Outer Diameter  
1,00 mm Different)

14-045820-10 D  
B : 103.330  
L : 227.280  
D : 106.420  
C : 3.800  
F : 0.900

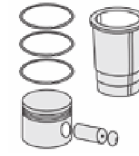

**Silindir Kit**  
(Assembly Set)

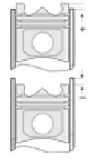

**Piston - Blok Montaj**  
Yüksekliği  
(Piston - Block  
Assembly Height)

+0,38/+0,53







MASSEY FERGUSON - Ø 98,48

87-71739-STD



**Motor Özellikleri**  
(Engine Specifications)

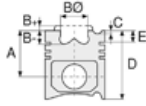

**Piston Ölçüleri**  
(Piston Dimensions)

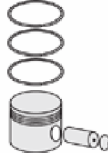

**Piston Parça No**  
(Piston Part No)



**Segman Seti**  
(Ring Set)



**Silindir Gömleği**  
(Liner)

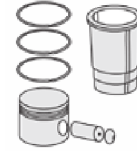

**Silindir Kit**  
(Assembly Set)

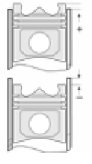

**Piston - Blok Montaj**  
Yüksekliği  
(Piston - Block  
Assembly Height)

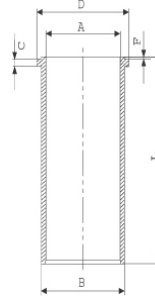

14-045821-10 D  
B: 103.830  
L: 227.280  
D: 106.920  
C: 4.300  
F: 0.900

Dış Çap 0,50mm Farklı  
(Outer Diameter  
0,50 mm Different)

14-045822-10 D  
B: 104.330  
L: 227.280  
D: 107.420  
C: 4.800  
F: 0.900

Dış Çap 1,00mm Farklı

14-045823-10 D  
B: 104.830  
L: 227.280  
D: 107.920  
C: 5.300  
F: 0.900





**Motor Özellikleri**  
(Engine Specifications)

İmalatçı (Manufacturer):  
MASSEY FERGUSON  
Çap (Diameter): Ø 101,054  
FM Grup No: 5606

**4.248**

4 Sil. Dizel 4064cc 61  
Kw (83 PS) 16:1  
PERKINS İLE  
ORTAK MOTOR  
(With Perkins Common  
Engine)  
DT 8000,  
MAHDRESCHER 307,506,  
MF 11/178/185/186/188,  
MF 175/345/840/920,  
MF 230 SS, MF 487,  
MF 85/178/185/186/18,  
R8000, RADLADER MF  
11/33/300/350/188-  
1969 - 1989

**4.248.2**

4 Sil. Dizel 4064cc  
60 KW(82 PS )  
PERKINS İLE  
ORTAK MOTOR  
(With Perkins Common  
Engine)  
MF 175/345/840/920  
1969 - 1989

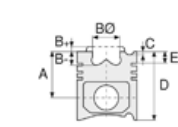

**Piston Ölçüleri**  
(Piston Dimensions)

A : 70.200  
B- : 21.000  
BØ : 61.450  
BX : 3.200  
D : 121.000  
E : 20.970

Pim : 34,925 x 84,1

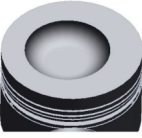

**Piston Özellikleri**  
(Piston Features)

Çelik Plaka  
(Steel Strut)  
Gözarası Düz  
(Flat Eye Gap)

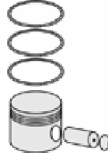

**Piston Parça No**  
(Piston Part No)

87-318000-02  
87-71753-STD  
  
87-318000-03  
87-71753-STD1  
0.28 mm kısa



**Segman Seti**  
(Ring Set)

06-318000-10-STD  
  
2.385 CRP İKA  
2.385 P STD  
2.385 P STD  
6.335 CRP STD



**Silindir Gömleği**  
(Liner)

14-040280-00-DH  
B : 104.230  
L : 227.300  
D : 107.400  
C : 3.800  
F : 0.850

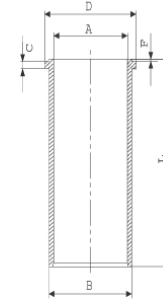

14-041140-00-D  
B : 104.350  
L : 227.280  
D : 107.440  
C : 3.800  
F : 0.900

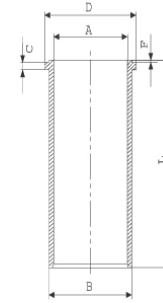

14-041141-10-D  
B : 104.850  
L : 227.280  
D : 107.440  
C : 3.800  
F : 0.900

Dış Çap 0,50mm Farklı  
(Outside Diameter  
0.50mm Different)

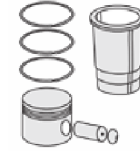

**Silindir Kit**  
(Assembly Set)

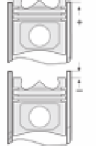

**Piston - Blok Montaj**  
Yüksekliği  
(Piston - Block  
Assembly Height)

+ 0,08 / + 0,25





**Motor Özellikleri**  
(Engine Specifications)

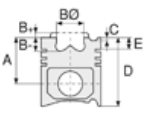

**Piston Ölçüleri**  
(Piston Dimensions)

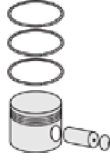

**Piston Parça No**  
(Piston Part No)



**Segman Seti**  
(Ring Set)



**Silindir Gömleği**  
(Liner)

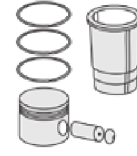

**Silindir Kit**  
(Assembly Set)

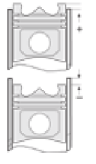

**Piston - Blok Montaj**  
**Yüksekliği**  
(Piston - Block  
Assembly Height)

14-041610-00-D  
B : 104.280  
L : 227.280  
D : 107.380  
C : 3.800  
F : 0.900

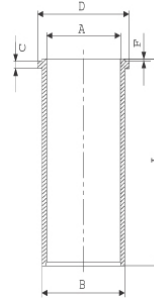



**Motor Özellikleri**  
(Engine Specifications)

İmalatçı (Manufacturer):  
MASSEY FERGUSON  
Çap (Diameter): Ø 108  
FM Grup No: 5618

**620 DWBAE Euro 3**  
6 Sil. Dizel 6600cc  
140 KW-190 PS  
8240  
2002..

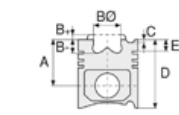

**Piston Ölçüleri**  
(Piston Dimensions)

A : 70.650  
B - : 17.900  
BØ : 60.000  
BX : 5.500  
BY : 3.000  
C1 : 0.800  
D : 106.600  
E : 13.300

Pim: 40 x 89

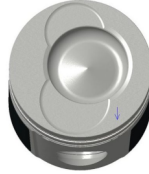

**Piston Özellikleri**  
(Piston Features)

Segman Taşıyıcı  
(Ring Carrier)  
Gözarası Konik  
(Conical Eye Gap)



**Piston Parça No**  
(Piston Part No)

87-882500-02  
87-72996-STD



**Segman Seti**  
(Ring Set)

06-882500-00 STD  
3.000 CK KV1  
2.500 P F14  
4.000 CR STD



**Silindir Gömleği**  
(Liner)

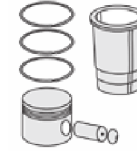

**Silindir Kit**  
(Assembly Set)

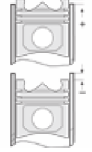

**Piston - Blok Montaj**  
Yüksekliği  
(Piston - Block  
Assembly Height)





MASSEY FERGUSON - Ø 108

87-73250-STD



**Motor Özellikleri**  
(Engine Specifications)

İmalatçı (Manufacturer):  
MASSEY FERGUSON  
Çap (Diameter): Ø 108  
FM Grup No: 5616

**620/634 DWBAE**

**Euro 3**

4 Sil. Dizel 6600cc  
140 KW-190 PS  
MF 8240, Valmet Tractors  
2002...

**620/634 DWBAE**

**Euro 3**

4 Sil. Dizel 6600cc 140  
KW-190 PS MF 8240,  
Valmet Tractors  
2002...

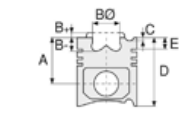

**Piston Ölçüleri**  
(Piston Dimensions)

A : 70.650  
B- : 19.000  
BØ : 64.500  
BX : 5.000  
BY : 3.300  
C1 : 0.800  
D : 106.800  
E : 13.300

Pim : 40 x 89

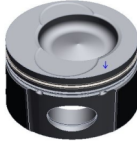

**Piston Özellikleri**  
(Piston Features)

Segman Taşıyıcı  
(Ring Carrier)  
Gözarası Konik  
(Conical Eye Gap)



**Piston Parça No**  
(Piston Part No)

87-888300-02  
87-73250-STD



**Segman Seti**  
(Ring Set)

06-888300-20-STD  
3.000 CR KV1  
2.500 P GOE  
4.000 CR GOE



**Silindir Gömleği**  
(Liner)

14-680130-00-WH  
B : 117.000  
L : 218.000  
D : 131.750  
C : 9.050  
F : 0.900

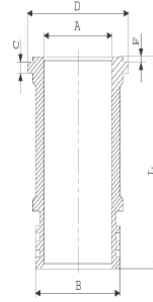

24-35051-90/0  
1x116.00\*3.50 FPM  
2x116.00\*3.50 EPDM

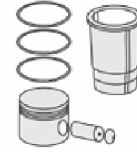

**Silindir Kit**  
(Assembly Set)

89-888300-02-STD  
89-73250-STD

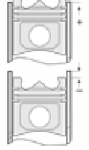

**Piston - Blok Montaj**  
Yüksekliği  
(Piston - Block  
Assembly Height)

