



SUBARU - Ø 77,7

87-73491-STD



Motor Özellikleri
(Engine Specifications)

İmalatçı (Manufacturer):
SUBARU
Çap (Diameter): Ø 77,7
FM Grup No: 6041

EL15
4 Sil. Benzinli 1498cc
74-81KW/101-110ps 10.0
IMPREZA
2006...

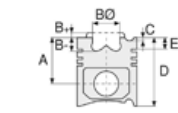

Piston Ölçüleri
(Piston Dimensions)

A : 30.800
C1 : 3.270
C2 : 3.520
D : 51.500
E : 5.200

Pim: 23 x 50



Piston Özellikleri
(Piston Features)

Sert Anotlama
(Hard Anodizing)
Gözarası Düz
(Flat Eye Gap)



Piston Parça No
(Piston Part No)

87-863400-02
87-73491-STD
87-863407-02
87-73491 0,50



Segman Seti
(Ring Set)

06-863400-50 STD
06-863407-50 0,50
1.200 CR ST
1.200 P GOE
2.000 CR ST

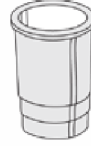

Silindir Gömleği
(Liner)

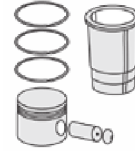

Silindir Kit
(Assembly Set)

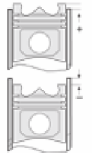

Piston - Blok Montaj
Yüksekliği
(Piston - Block
Assembly Height)





SUBARU - Ø 92

87-73490-STD



Motor Özellikleri
(Engine Specifications)

İmalatçı (Manufacturer):
SUBARU
Çap (Diameter): Ø 92
FM Grup No: 6040

EJ20
4 Sil. Benzinli 1994cc
82-130KW /112-177 ps 9.5
FORESTER, IMPREZA,
LEGACY
2006...

Piston Ölçüleri
(Piston Dimensions)

A : 32.700
C1 : 4.570
D : 55.900
E : 6.000

Pim: 23 x 58



Piston Özellikleri
(Piston Features)

Sert Anotlama
(Hard Anodizing)
Gözarası Düz
(Flat Eye Gap)



Piston Parça No
(Piston Part No)

87-866200-02
87-73490-STD

87-866207-02
87-73490 0,50



Segman Seti
(Ring Set)

06-866200-50-STD
06-866207-50 0,50

1.200 CR ST
1.200 P GOE
2.000 CR GOE



Silindir Gömleği
(Liner)

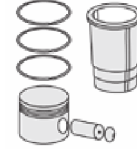

Silindir Kit
(Assembly Set)

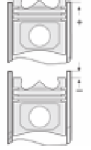

Piston - Blok Montaj
Yüksekliği
(Piston - Block
Assembly Height)

